



Flat 2, 328 Uxbridge Road, London, W12 7LJ

LONG LET. A spectacular one bedroom flat situated in heart of Shepherds Bush and boasting a modern interior.

- MODERN INTERIOR
- CLOSE TO TRANSPORT
- SEPARATE KITCHEN
- CLOSE TO AMENITIES
- NEW REFURBISHMENT
- AVAILABLE NOW

£1,550 PCM

Uxbridge Road

Approximate Gross Internal Area
463 sq ft - 43 sq m

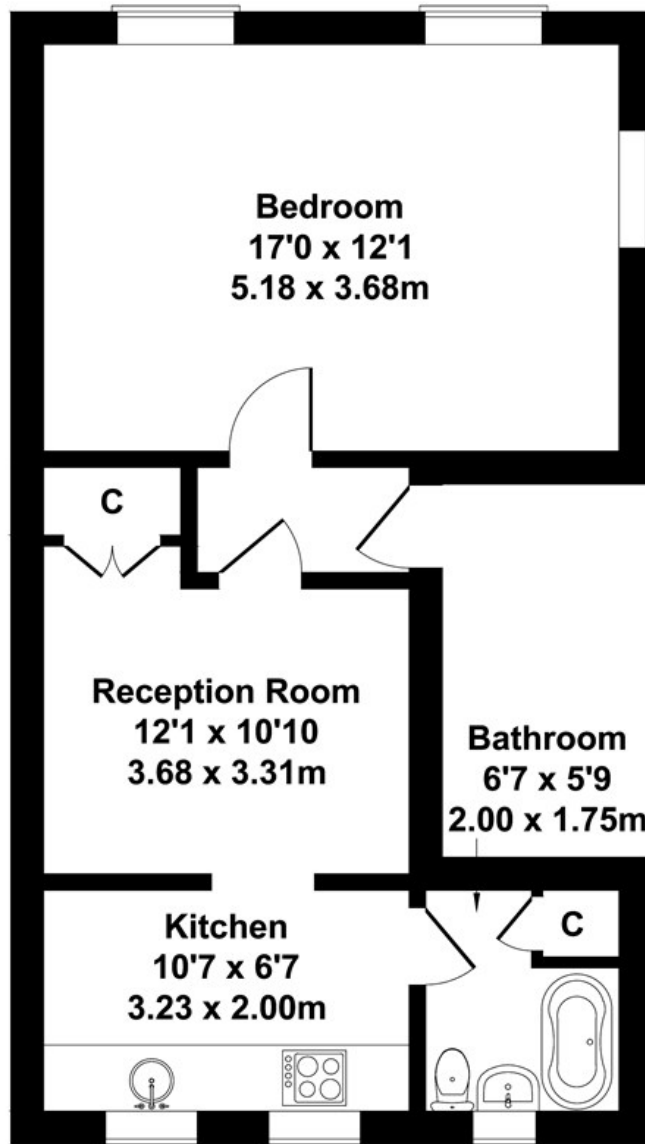

SECOND FLOOR

Not to Scale. Produced by The Plan Portal 2021
For Illustrative Purposes Only.

Energy Efficiency Rating		
	Current	Potential
<i>Very energy efficient - lower running costs</i>		
(92 plus) A		
(81-91) B		
(69-80) C		
(55-68) D		
(39-54) E		
(21-38) F		
(1-20) G		
<i>Not energy efficient - higher running costs</i>		
England & Wales	EU Directive 2002/91/EC	