



Allison Road, W3

LONG LET. This one bedroom apartment offers stylish accommodation which benefits from a modern interior and a great location close to local transport links.

- Walking distance to the Elizabeth Line
- Open plan
- Great for local amenities
- Available from 3rd June 2026
- Modern Interior

£1,775 PCM

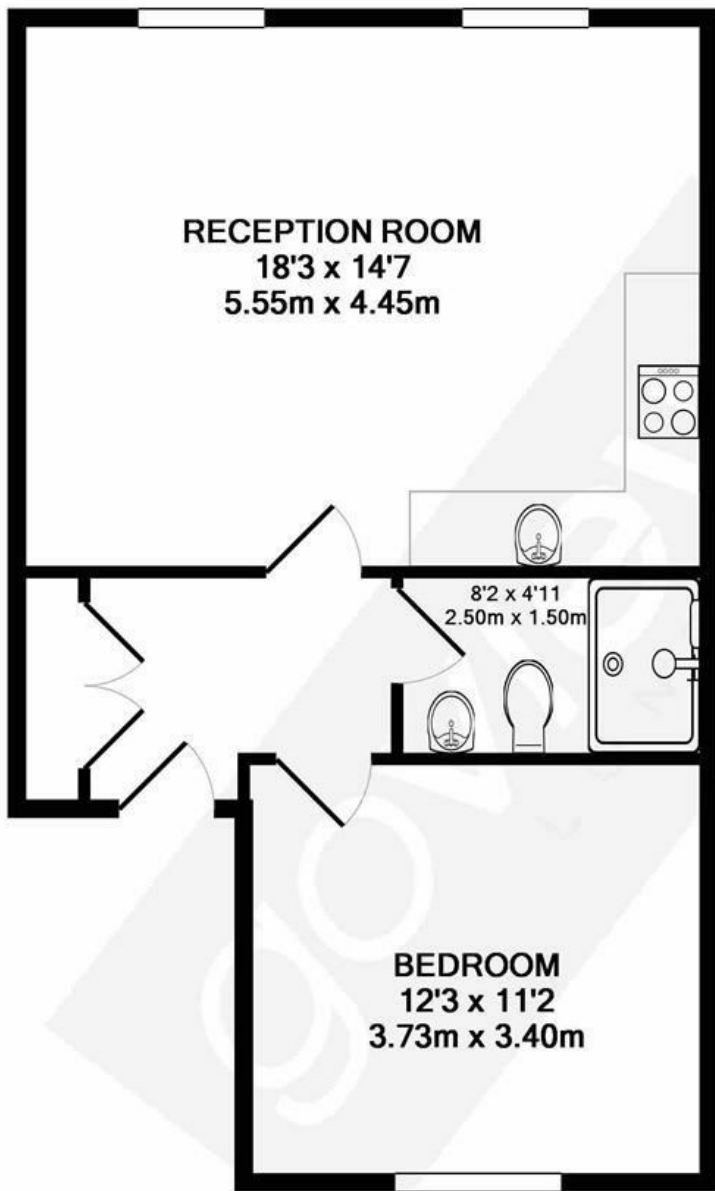

RECEPTION ROOM
 18'3 x 14'7
 5.55m x 4.45m

8'2 x 4'11
 2.50m x 1.50m

BEDROOM
 12'3 x 11'2
 3.73m x 3.40m

TOTAL APPROX. FLOOR AREA 500 SQ.FT. (46.4 SQ.M.)

Whilst every attempt has been made to ensure the accuracy of the floor plan contained here, measurements of doors, windows, rooms and any other items are approximate and no responsibility is taken for any error, omission, or mis-statement. This plan is for illustrative purposes only and should be used as such by any prospective purchaser. The services, systems and appliances shown have not been tested and no guarantee as to their operability or efficiency can be given

Made with Metropix ©2019

Energy Efficiency Rating		
	Current	Potential
<i>Very energy efficient - lower running costs</i>		
(92 plus) A		
(81-91) B		
(69-80) C		
(55-68) D		
(39-54) E		
(21-38) F		
(1-20) G		
<i>Not energy efficient - higher running costs</i>		
England & Wales	EU Directive 2002/91/EC	