

Colonnade Gardens, W3

A beautifully presented one-bedroom apartment set within the popular Colonnade Gardens development, offered in immaculate condition and ready to move into.

The property features a bright and spacious reception room, complemented by a well-appointed separate kitchen finished to a high standard. The generous double bedroom provides comfortable accommodation, while the bathroom is modern and tastefully presented.

The apartment has been meticulously maintained, creating an ideal home for first-time buyers or investors seeking a property with no work required.

Further benefits include lift access within the building and access to well-kept communal gardens, offering a peaceful and attractive setting.

£400,000

- One-bedroom apartment
- Immaculately presented throughout
- Lift access
- Bright and spacious
- Modern, well-finished kitchen
- Stylish bathroom
- Access to well-maintained communal gardens
- Excellent transport links
- Private balcony
- EPC B

Leighfield Court

Approximate Gross Internal Area
570 sq ft - 53 sq m

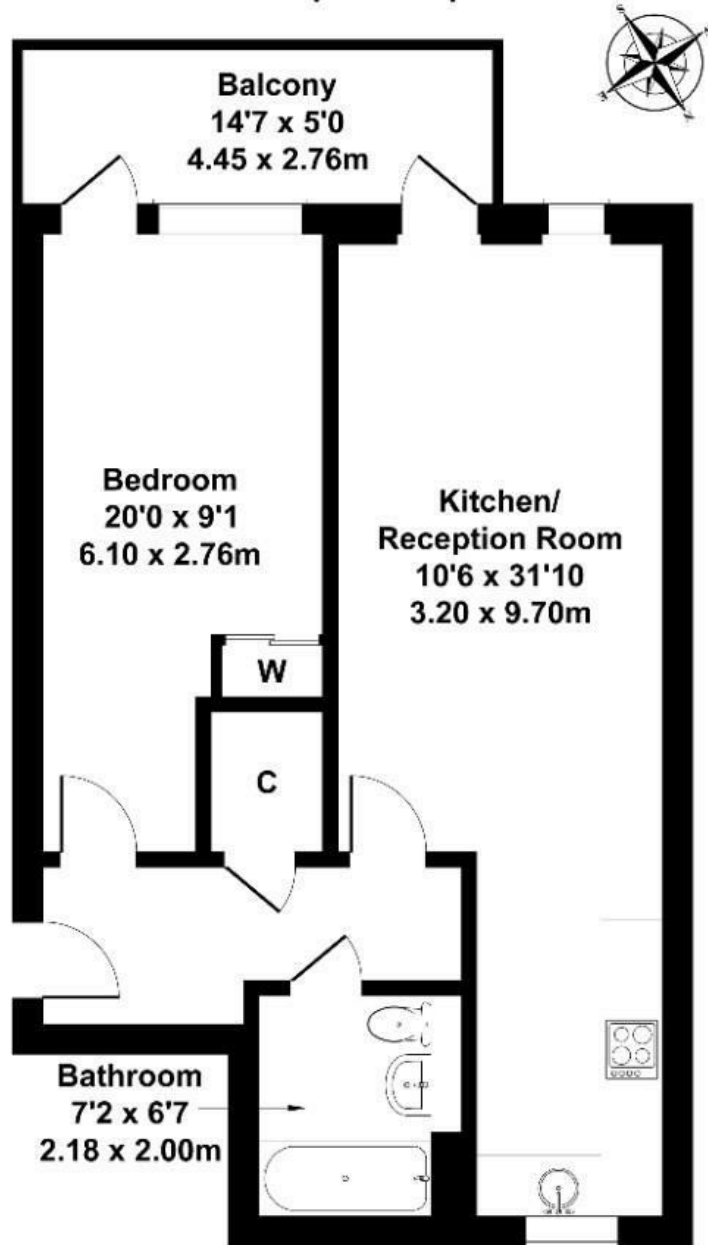

FIFTH FLOOR

Not to Scale. Produced by The Plan Portal 2026
For Illustrative Purposes Only.

Energy Efficiency Rating		Current	Potential
Very energy efficient - lower running costs			
(92 plus) A			
(81-91) B		85	85
(69-80) C			
(55-68) D			
(39-54) E			
(21-38) F			
(1-20) G			
Not energy efficient - higher running costs			
England & Wales	EU Directive 2002/91/EC		