



Agnes Road, W3

LONG LET. A stunning four bedroom house located in a quite residential street offering stylish accommodation which benefits from a modern interior and a great location close to local transport links.

- Built in sound system
- Underfloor heating
- Three bathrooms
- Great family home
- Early viewings advised
- Large garden

£4,150 PCM

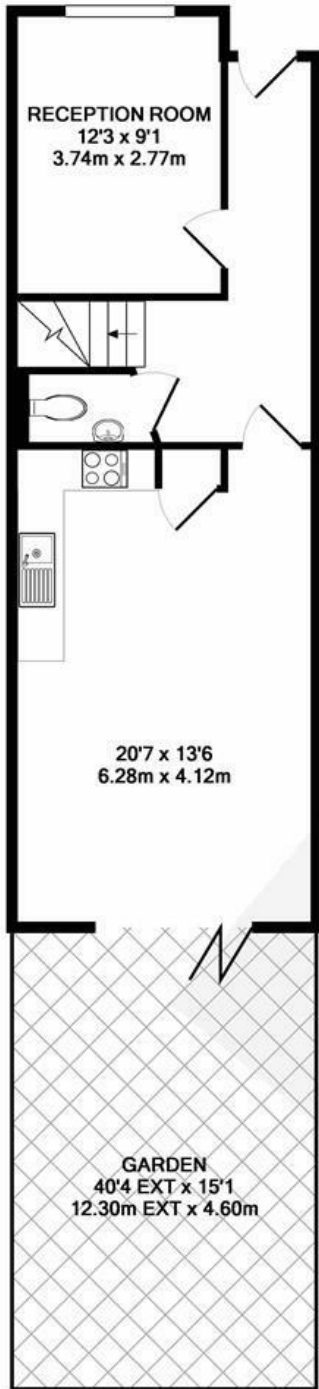

GROUND FLOOR
APPROX. FLOOR
AREA 501 SQ.FT.
(46.5 SQ.M.)

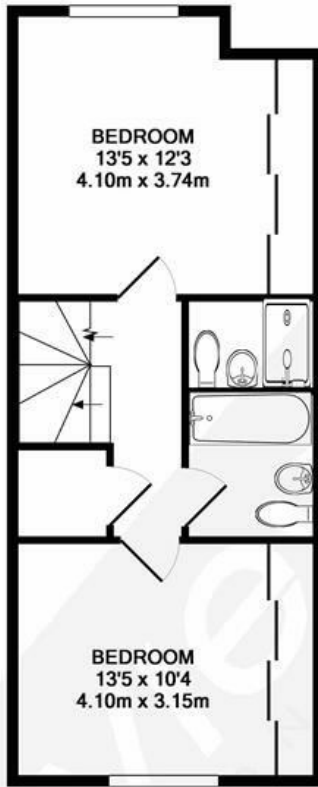

1ST FLOOR
APPROX. FLOOR
AREA 424 SQ.FT.
(39.4 SQ.M.)

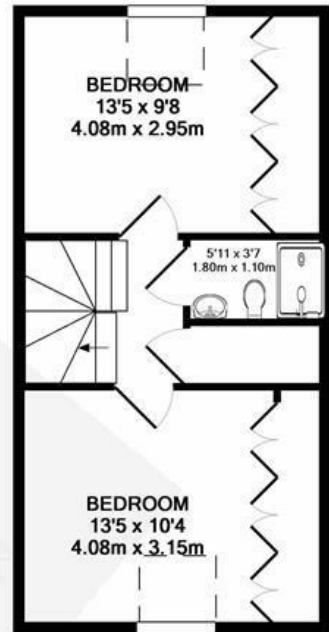

2ND FLOOR
APPROX. FLOOR
AREA 345 SQ.FT.
(32.1 SQ.M.)

TOTAL APPROX. FLOOR AREA 1270 SQ.FT. (118.0 SQ.M.)

Whilst every attempt has been made to ensure the accuracy of the floor plan contained here, measurements of doors, windows, rooms and any other items are approximate and no responsibility is taken for any error, omission, or mis-statement. This plan is for illustrative purposes only and should be used as such by any prospective purchaser. The services, systems and appliances shown have not been tested and no guarantee as to their operability or efficiency can be given
Made with Metropix ©2019

Energy Efficiency Rating		
	Current	Potential
<i>Very energy efficient - lower running costs</i>		
(92 plus) A		
(81-91) B		
(69-80) C		
(55-68) D		
(39-54) E		
(21-38) F		
(1-20) G		
<i>Not energy efficient - higher running costs</i>		
England & Wales	EU Directive 2002/91/EC	