



## Osterley Park View Road, London

A bright and well presented one double bedroom ground floor flat with allocated off-street parking. Offered with no onward chain, this is a fantastic opportunity for either a first time buyer, downsizer or investor to buy in a highly accessible London setting.

- Ground Floor Flat
- Double Bedroom
- Allocated Parking
- Long Lease
- No Onward Chain
- Close to Hanwell Station (Elizabeth Line)

Asking Price £329,950

# Osterly Park View Road

Approximate Gross Internal Area  
463 sq ft - 43 sq m



**Kitchen**  
7'5 x 7'4  
2.25 x 2.23m

**Bedroom**  
13'1 x 8'11  
4.00 x 2.72m

**Reception Room**  
16'5 x 12'4  
5.00 x 3.77m

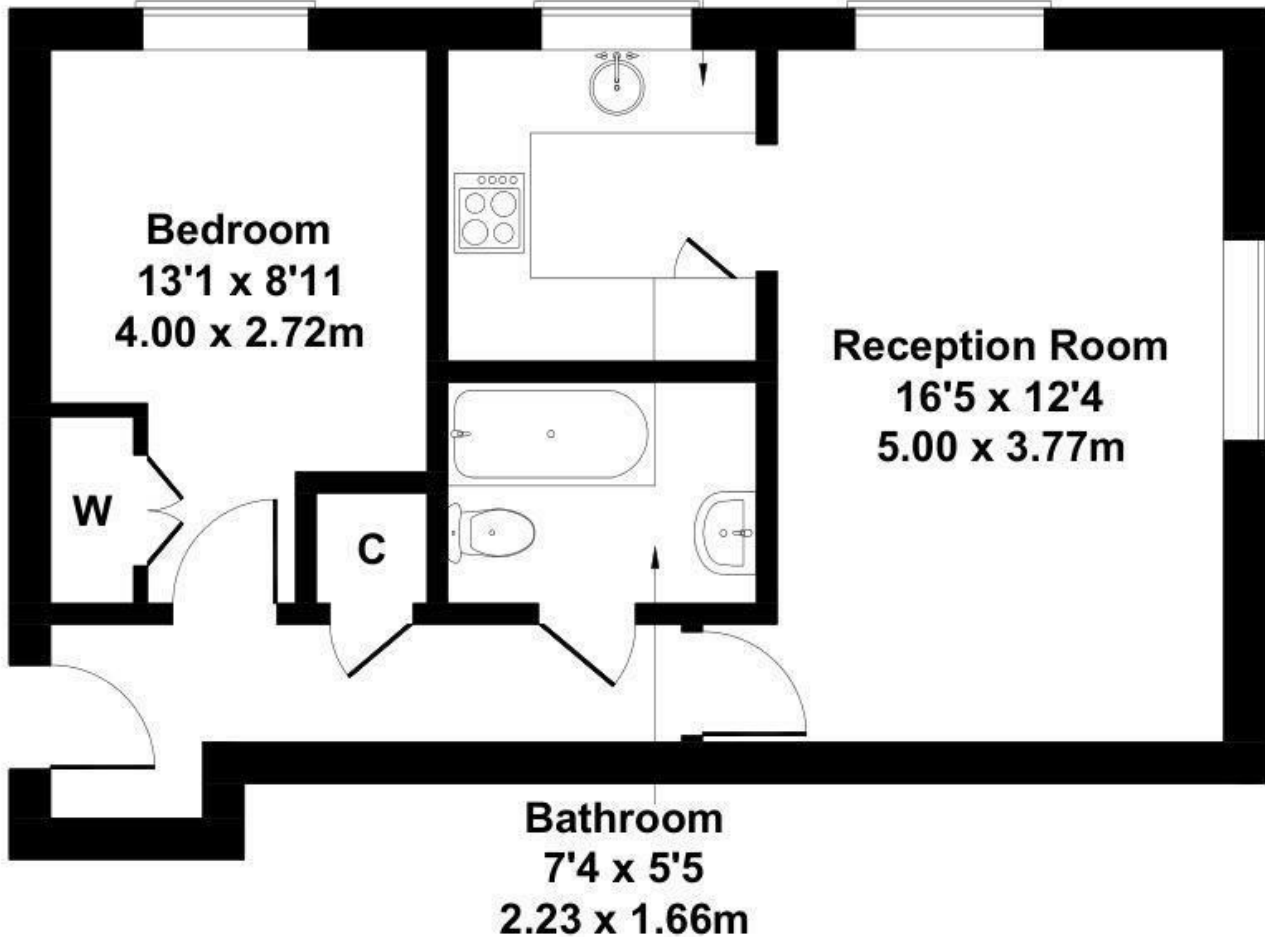

## GROUND FLOOR

Not to Scale. Produced by The Plan Portal 2026  
For Illustrative Purposes Only.

Energy Efficiency Rating		
	Current	Potential
<i>Very energy efficient - lower running costs</i>		
(92 plus) <b>A</b>		
(81-91) <b>B</b>		
(69-80) <b>C</b>	74	76
(55-68) <b>D</b>		
(39-54) <b>E</b>		
(21-38) <b>F</b>		
(1-20) <b>G</b>		
<i>Not energy efficient - higher running costs</i>		
<b>England &amp; Wales</b>	EU Directive 2002/91/EC	