



Woodville Gardens, W5

LONG LET. Well located close to transport links and amenities this well presented one bedroom flat boasts a great location in the heart of Ealing Broadway.

- ONE BEDROOM FLAT
- GREAT LOCATION
- PRIVATE PARKING
- EALING BROADWAY
- COMMUNAL GARDEN
- CLOSE TO STATION

£1,600 PCM

Flat 6 - Woodville Gardens

Approximate Gross Internal Area
549 sq ft - 51 sq m

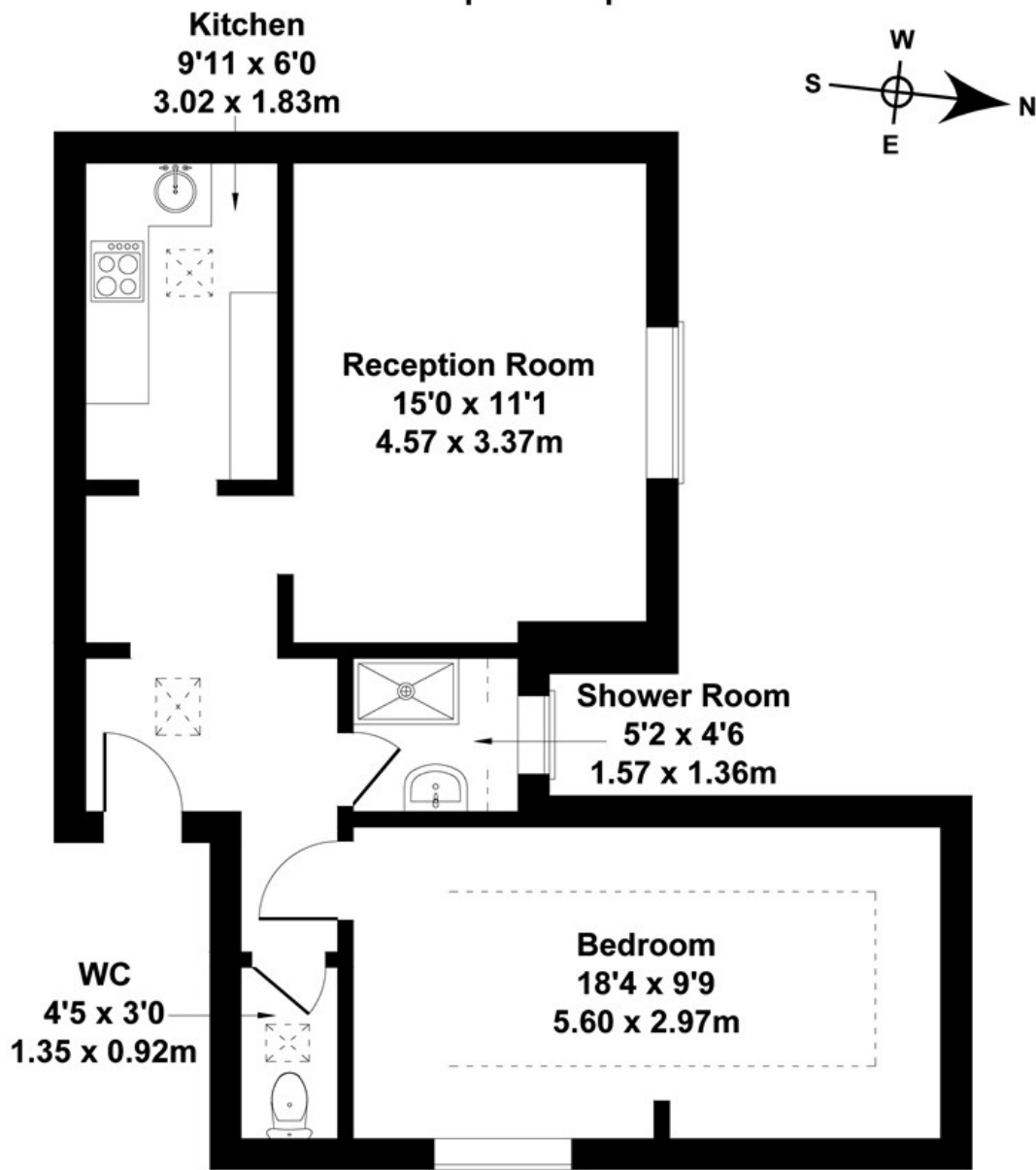

SECOND FLOOR

Not to Scale. Produced by The Plan Portal 2021
For Illustrative Purposes Only.

Energy Efficiency Rating		
	Current	Potential
Very energy efficient - lower running costs		
(92 plus) A		
(81-91) B		
(69-80) C		
(55-68) D		
(39-54) E		
(21-38) F		
(1-20) G		
Not energy efficient - higher running costs		
England & Wales	EU Directive 2002/91/EC 