



## Uxbridge Road, W12

LONG LET. A spectacular one bedroom flat situated in heart of Shepherd's Bush and boasting a modern interior.

- MODERN INTERIOR
- CLOSE TO TRANSPORT
- SEPARATE KITCHEN
- CLOSE TO AMENITIES
- AVAILABLE NOW

£1,650 PCM

# Uxbridge Road

Approximate Gross Internal Area  
463 sq ft - 43 sq m

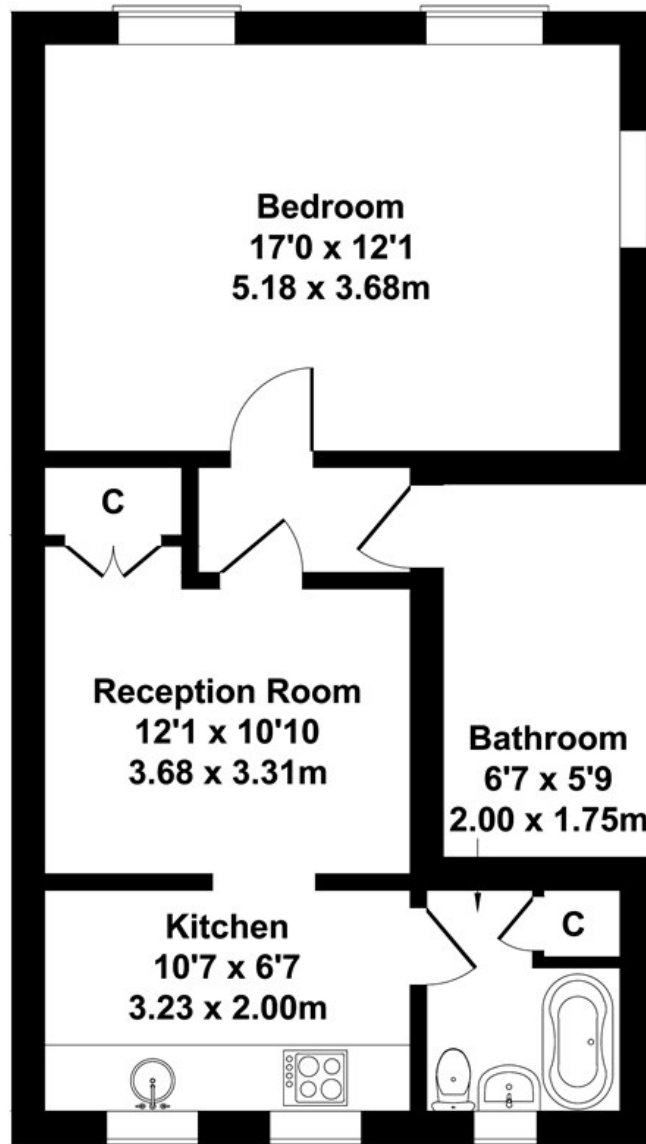

## SECOND FLOOR

Not to Scale. Produced by The Plan Portal 2021  
**For Illustrative Purposes Only.**

Energy Efficiency Rating		
	Current	Potential
Very energy efficient - lower running costs		
(92 plus) <b>A</b>		
(81-91) <b>B</b>		
(69-80) <b>C</b>		
(55-68) <b>D</b>		
(39-54) <b>E</b>		
(21-38) <b>F</b>		
(1-20) <b>G</b>		
Not energy efficient - higher running costs		
<b>England &amp; Wales</b>	EU Directive 2002/91/EC	