



## Greystoke Gardens, London

LONG LET. A stylish recently refurbished two double bedroom purpose built apartment with a large kitchen and reception rooms close to Hanger Lane.

- TWO DOUBLE BEDROOMS
- CLOSE TO STATIONS AND LOCAL TRANSPORT
- GREAT FOR MOTORISTS
- RECENTLY RE-PAINTED
- LARGE LIVING AREA
- CLOSE TO AMENITIES

£2,100

# Greystoke Gardens

Approximate Gross Internal Area  
743 sq ft - 69 sq m

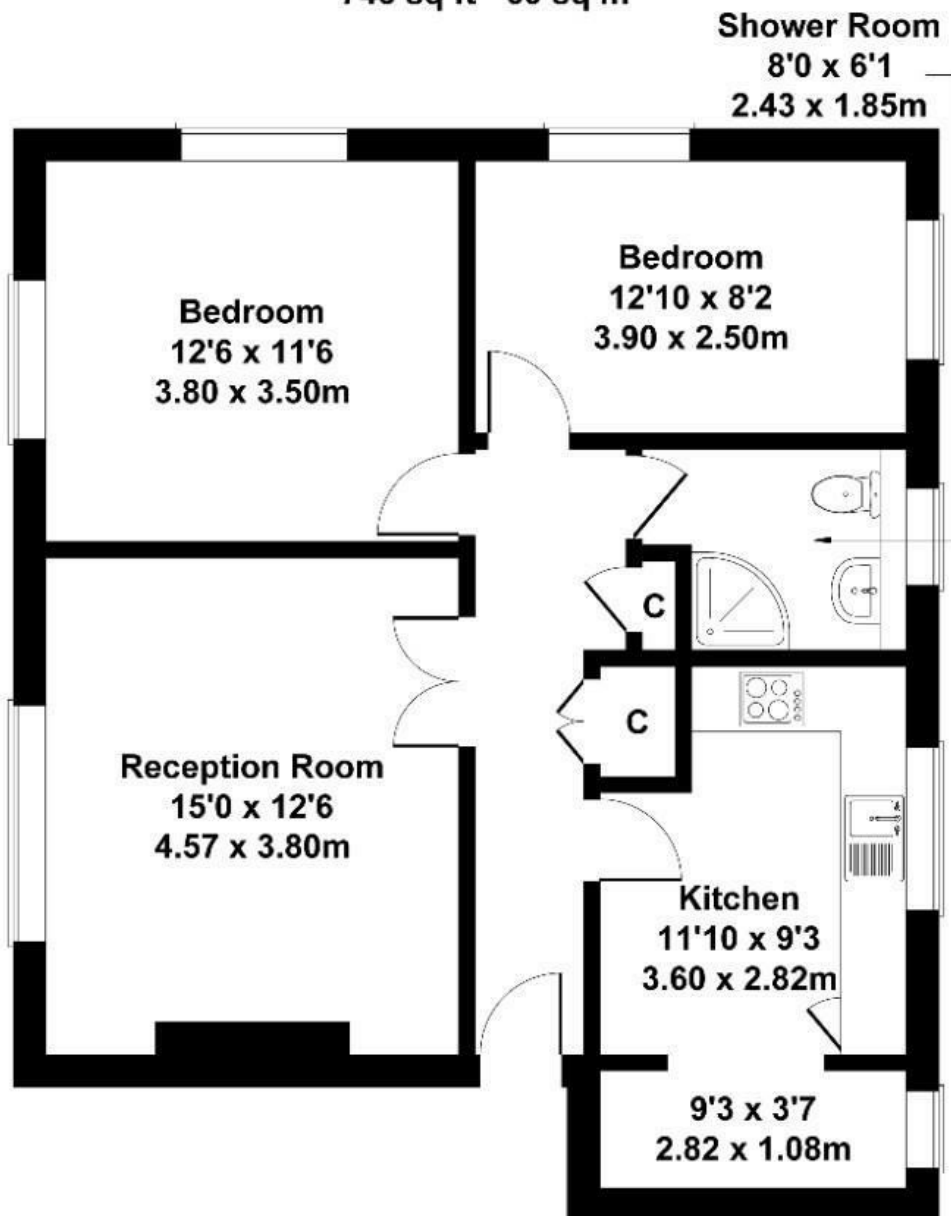

## SECOND FLOOR

Not to Scale. Produced by The Plan Portal 2025  
For Illustrative Purposes Only.

Energy Efficiency Rating		
	Current	Potential
Very energy efficient - lower running costs		
(92 plus) A		
(81-91) B		
(69-80) C	78	
(55-68) D		
(39-54) E		
(21-38) F		
(1-20) G		
Not energy efficient - higher running costs		
England & Wales		EU Directive 2002/91/EC