



Stanley Road, W3

This contemporary two-bedroom, two-bathroom apartment is set within the highly regarded Acton Gardens development.

Positioned on the fifth floor, it boasts a private balcony with far-reaching views across Chiswick and towards central London, as well as access to communal gardens.

Its generous windows flood the property with natural light.

The property is being offered to the market with no onward chain.

- Two double bedrooms
- Two bathrooms (one en-suite)
- Fifth floor
- Stunning viewings
- Private balcony
- Close to transport links
- Lift access
- No onward chain

£525,000

Wellbeck Court

Approximate Gross Internal Area

House : 807 sq ft - 75 sq m

Balcony : 86 sq ft - 8 sq m

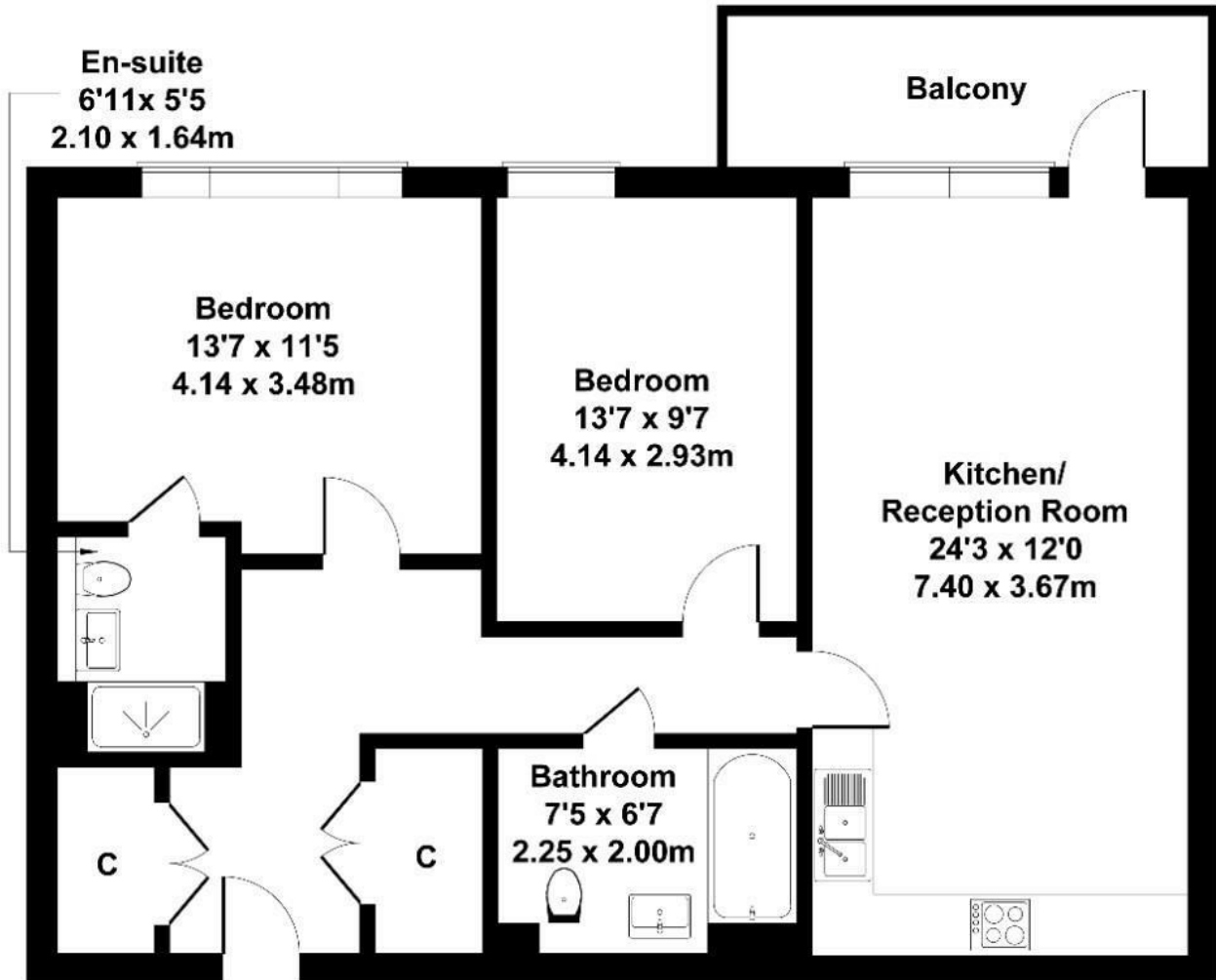

Not to Scale. Produced by The Plan Portal 2025
For Illustrative Purposes Only.

Energy Efficiency Rating		
	Current	Potential
Very energy efficient - lower running costs		
(92 plus) A		
(81-91) B	87	87
(69-80) C		
(55-68) D		
(39-54) E		
(21-38) F		
(1-20) G		
Not energy efficient - higher running costs		
England & Wales	EU Directive 2002/91/EC	