



Saxon Drive, W3

Long Let. Nestled in the desirable area of Saxon Drive, W3, this charming newly refurbished three-bedroom house offers a perfect blend of modern living and comfort.

- Available now
- Newly refurbished three/four bedroom house
- All brand new appliances
- Large beautiful garden
- Ideal location for schools and local amenities
- Great transport links

£2,999

Saxon Drive

Approximate Gross Internal Area
936 sq ft - 87 sq m

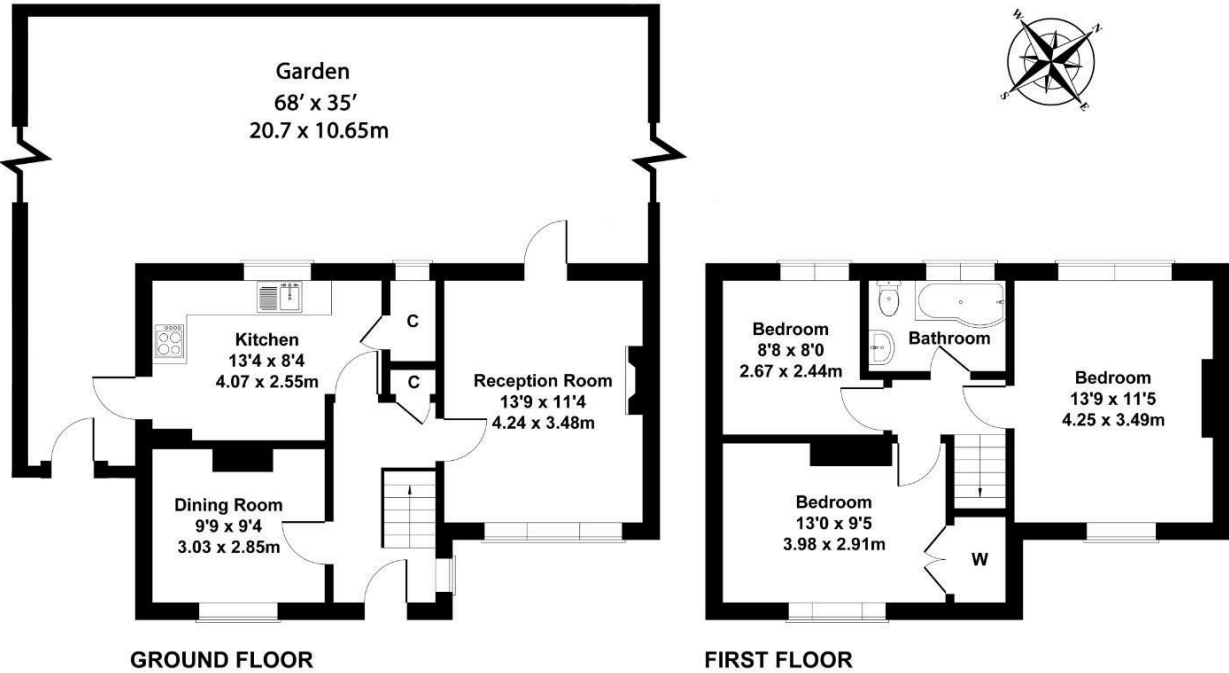

Not to Scale. Produced by The Plan Portal 2025
For Illustrative Purposes Only.

