



Inglis Road, W5

LONG LET. Excellently located for amenities and transport links this new build one bedroom flat is set within an exceptional development, offering generous living space and a modern interior.

- ONE BEDROOM APARTMENT
- MODERN INTERIOR
- OPEN PLAN LIVING
- CLOSE TO AMENITIES
- CLOSE TO LOCAL TRANSPORT
- UNFURNISHED

£1,900 PCM

Inglis Road

Approximate Gross Internal Area
House - 614 sq ft - 57 sq m
Internal Balcony - 43 sq ft - 4 sq m
Total - 657 sq ft - 61 sq m

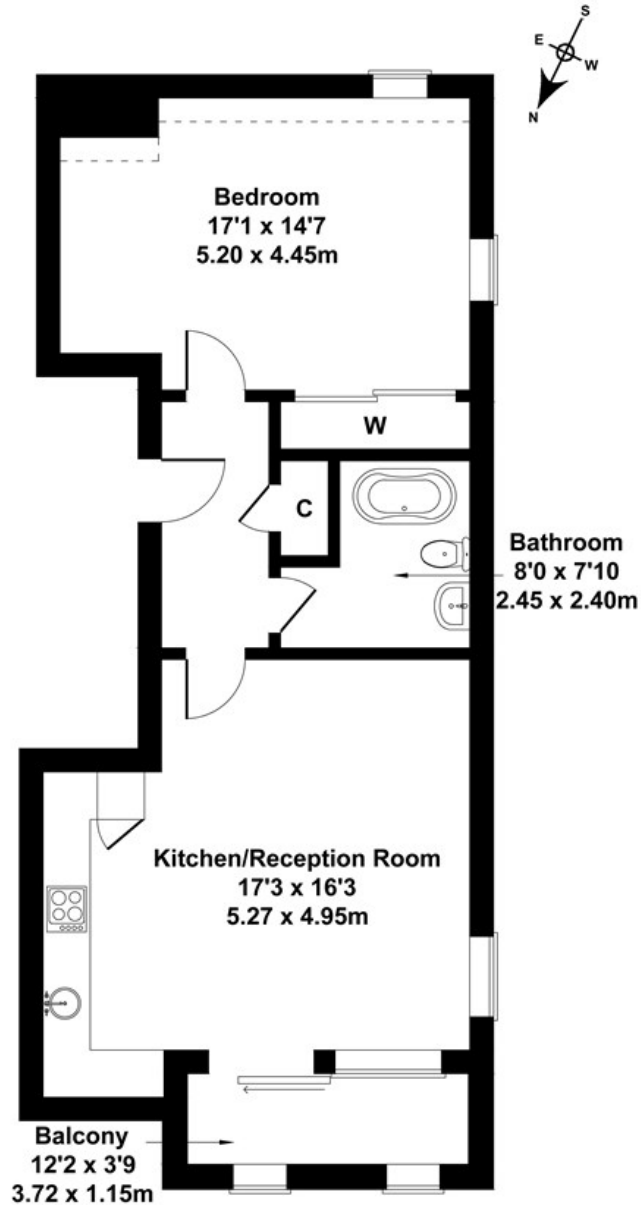

SECOND FLOOR

Not to Scale. Produced by The Plan Portal 2023
For Illustrative Purposes Only.

Energy Efficiency Rating		
	Current	Potential
Very energy efficient - lower running costs		
(92 plus) A		
(81-91) B		
(69-80) C		
(55-68) D		
(39-54) E		
(21-38) F		
(1-20) G		
Not energy efficient - higher running costs		
England & Wales	EU Directive 2002/91/EC	