



Lampton Road, TW3

LONG LET. A modern and superbly situated studio is situated on a popular road in Hounslow and is ideal for commuting into central London and Heathrow airport.

- Parking available
- Modern studio
- Available now
- Close to local amenities
- Great for local transport

£1,000 PCM

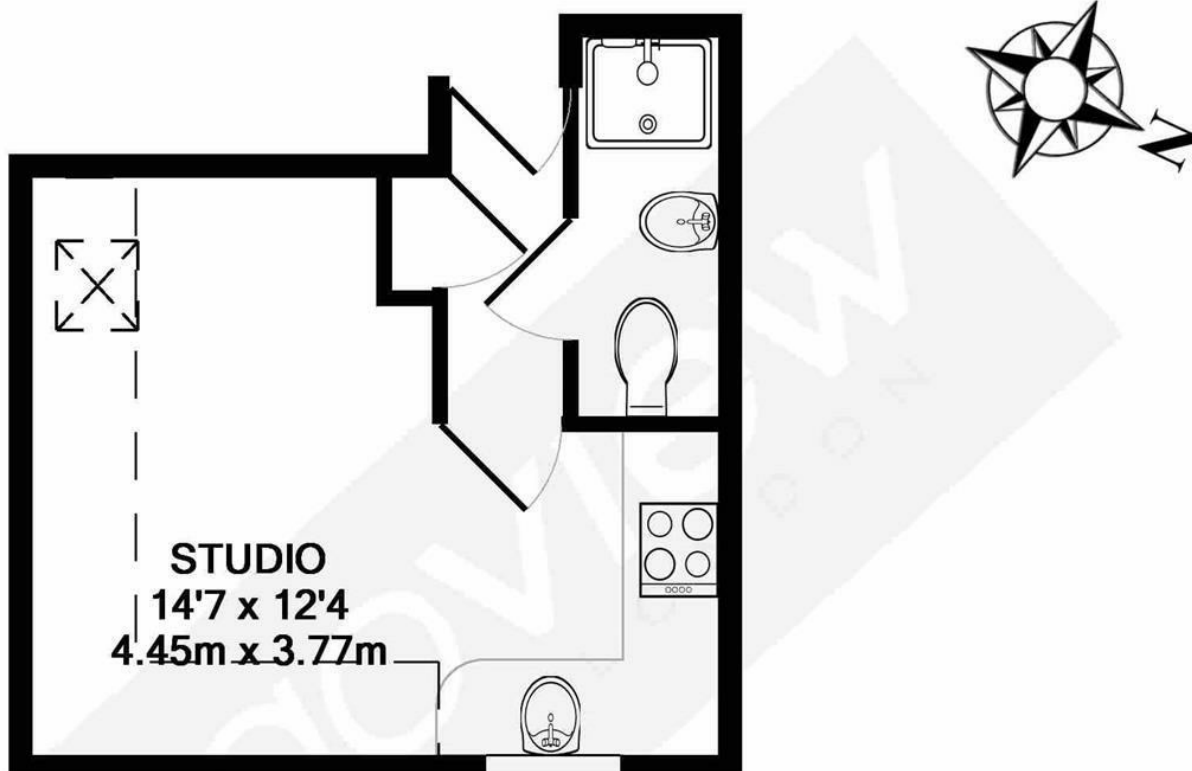

TOTAL APPROX. FLOOR AREA 194 SQ.FT. (18.1 SQ.M.)

Whilst every attempt has been made to ensure the accuracy of the floor plan contained here, measurements of doors, windows, rooms and any other items are approximate and no responsibility is taken for any error, omission, or mis-statement. This plan is for illustrative purposes only and should be used as such by any prospective purchaser. The services, systems and appliances shown have not been tested and no guarantee as to their operability or efficiency can be given

Made with Metropix ©2019

Energy Efficiency Rating		
	Current	Potential
Very energy efficient - lower running costs		
(92 plus) A		
(81-91) B		
(69-80) C		
(55-68) D		
(39-54) E		
(21-38) F		
(1-20) G		
Not energy efficient - higher running costs		
England & Wales	EU Directive 2002/91/EC	