



Ealing Village, W5

Situated on the second floor of a Grade II-listed Art Deco estate, this bright and spacious apartment offers over 700 sq ft of well-appointed living space.

Ealing Village is a sought-after development, renowned for its extensive communal gardens and excellent resident amenities.

The flat includes one bathroom, a separate kitchen, and a generously sized south-facing reception room with direct access to a balcony that overlooks beautifully maintained communal grounds.

Additional features include a gated entrance, a private road, ample parking, and exclusive access to on-site facilities such as a clubhouse, swimming pool, and tennis court.

- Three bedrooms
- Second-floor apartment
- Gated secure development with ample parking
- Swimming pool, tennis court, club house (games room)
- Over 700 sq ft
- Close to transport links
- No chain
- Offers invited

£428,500

Ealing village

Approximate Gross Internal Area
700 sq ft - 65 Sq M

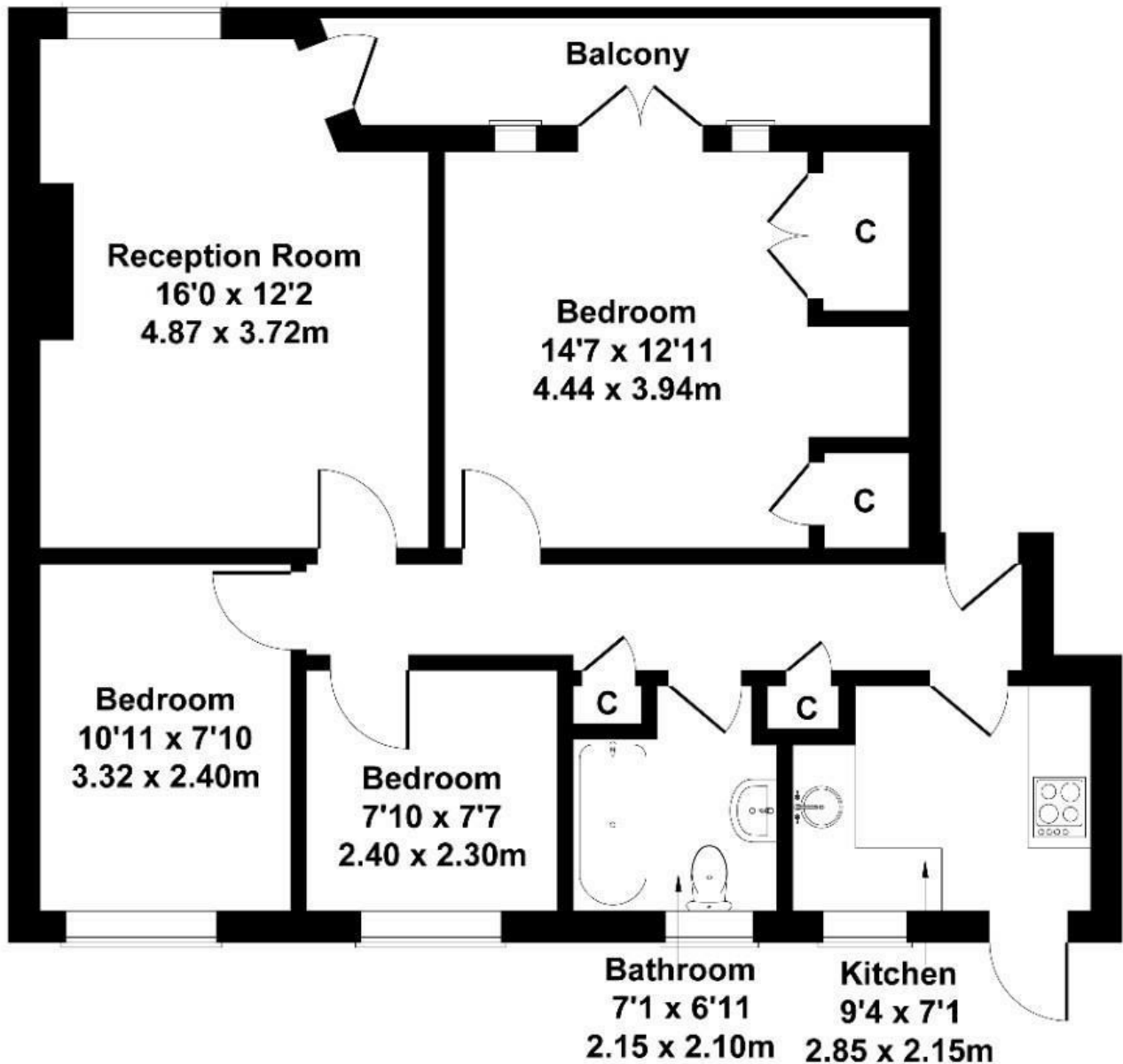

Not to Scale. Produced by The Plan Portal 2025
For Illustrative Purposes Only.

Energy Efficiency Rating		
	Current	Potential
Very energy efficient - lower running costs		
(92 plus) A		
(81-91) B		
(69-80) C		
(55-68) D		
(39-54) E		
(21-38) F		
(1-20) G		
Not energy efficient - higher running costs		
England & Wales	EU Directive 2002/91/EC	