

Highland Avenue, W7

LONG LET: This beautifully presented four-bedroom house, featuring a contemporary interior, is ideally located on a quiet residential street, Highland Avenue, in the heart of Hanwell.

- Modern family home
- Open-plan kitchen
- Ensuite top bedroom
- Garden and permit parking
- Excellent transport links
- Available 1st September

£3,300

Highland ave

Approximate Gross Internal Area
1367 sq ft - 127 sq m

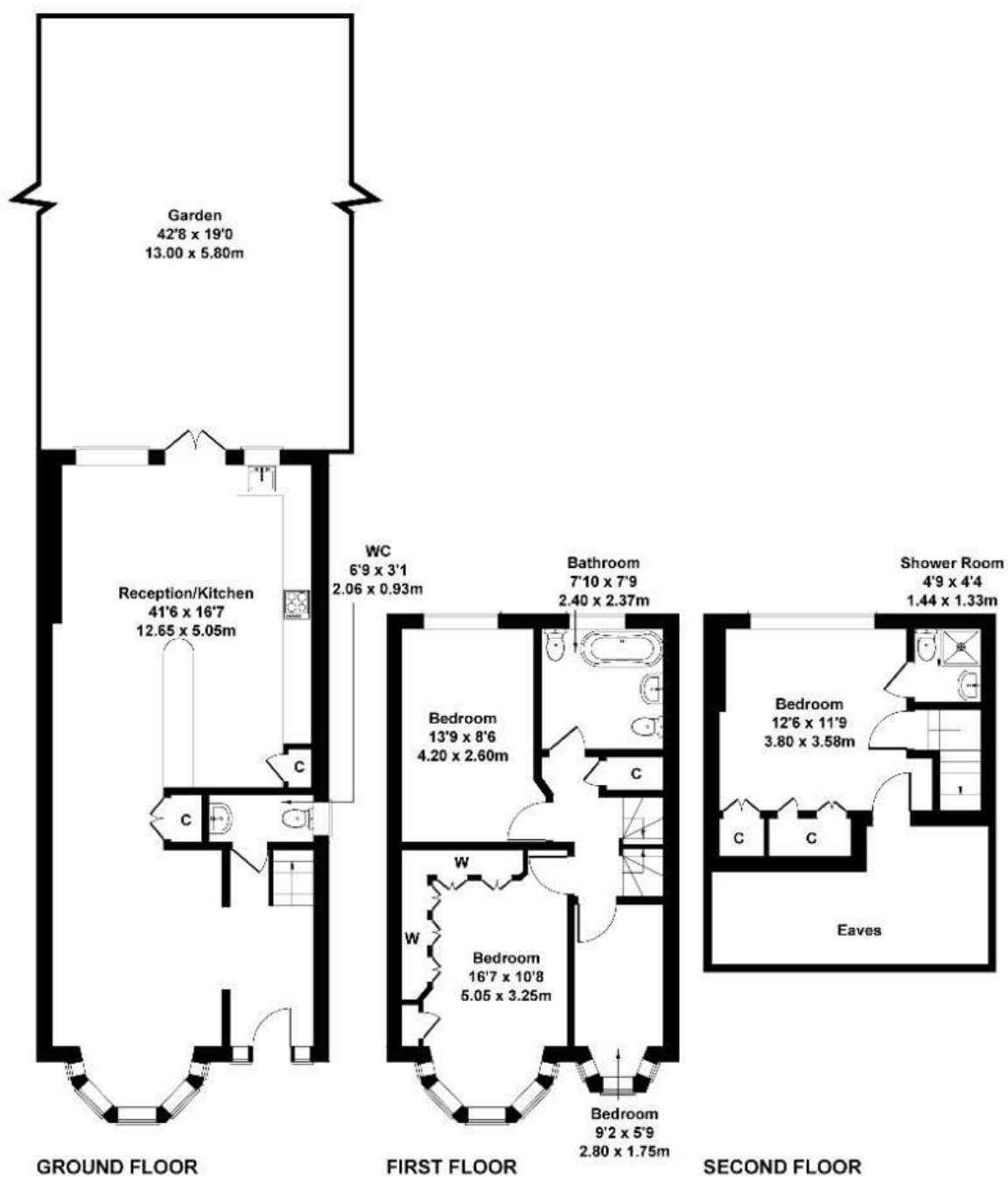

Not to Scale. Produced by The Plan Portal 2025
For Illustrative Purposes Only.

Energy Efficiency Rating		
	Current	Potential
Very energy efficient - lower running costs		
(92 plus) A		
(81-91) B		
(69-80) C		
(55-68) D		
(39-54) E		
(21-38) F		
(1-20) G		
Not energy efficient - higher running costs		
England & Wales	EU Directive 2002/91/EC	