



## Uxbridge Road, W5

A large one bedroom apartment, measuring over 500 sq ft with underground parking, within walking distance to Ealing Broadway and offering spacious, convenience and security all in a central location.

- Purpose built
- Large one bedroom apartment
- Underground allocated parking
- Second floor
- Communal gardens
- Multiple transport stations close by
- No chain
- Excellent order throughout
- Elizabeth Line
- Lift

£325,000

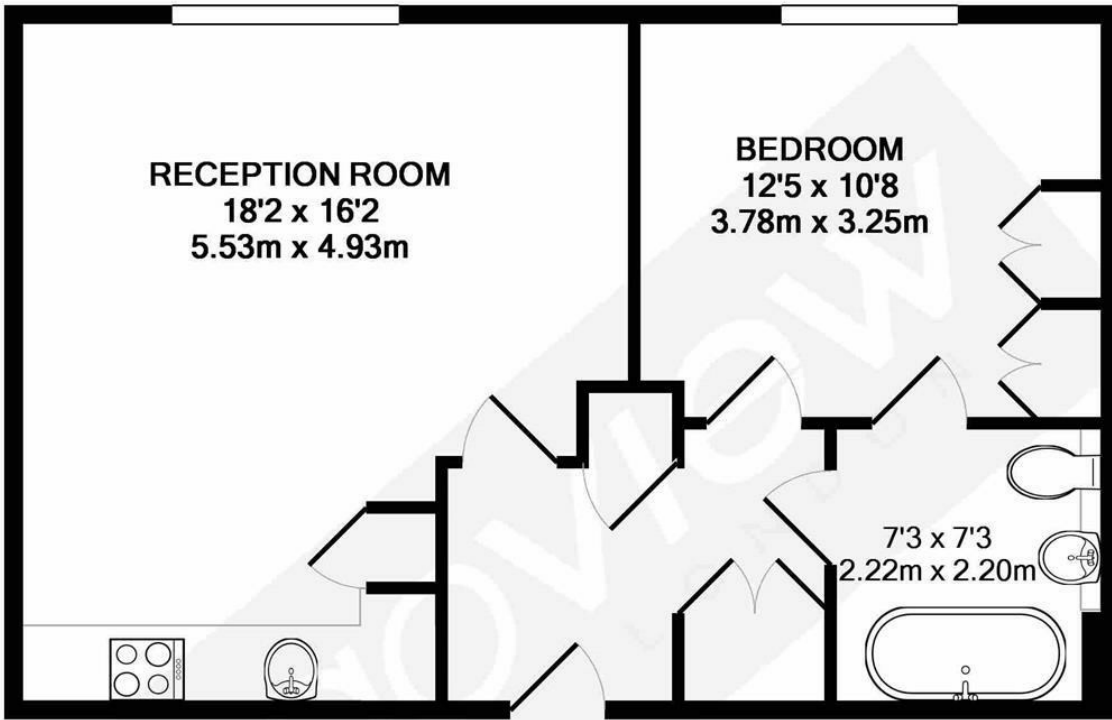

TOTAL APPROX. FLOOR AREA 517 SQ.FT. (48.0 SQ.M.)

Whilst every attempt has been made to ensure the accuracy of the floor plan contained here, measurements of doors, windows, rooms and any other items are approximate and no responsibility is taken for any error, omission, or mis-statement. This plan is for illustrative purposes only and should be used as such by any prospective purchaser. The services, systems and appliances shown have not been tested and no guarantee as to their operability or efficiency can be given  
 Made with Metropix ©2018



Energy Efficiency Rating		
	Current	Potential
Very energy efficient - lower running costs		
(92 plus) <b>A</b>		
(81-91) <b>B</b>		
(69-80) <b>C</b>	79	81
(55-68) <b>D</b>		
(39-54) <b>E</b>		
(21-38) <b>F</b>		
(1-20) <b>G</b>		
Not energy efficient - higher running costs		
<b>England &amp; Wales</b>	EU Directive 2002/91/EC	