



Cumberland Road, London

Nestled in a highly sought-after, tree-lined residential street, this immaculately presented one bedroom ground floor Edwardian maisonette seamlessly blends timeless period charm with contemporary living. Benefiting from a share of freehold, this character-filled home occupies the entire ground floor of an attractive Edwardian conversion, offering an abundance of original features, including high ceilings, ornate cornicing, sash windows, and a beautiful fireplace.

- One double bedroom ground floor maisonette
- Share of freehold
- Stylish interiors throughout
- Excellent transport links via Piccadilly & Elizabeth Lines
- Walking distance to Hanwell, Northfields & Ealing amenities
- Ideal first-time buy or investment

£399,950

Cumberland Road

Approximate Gross Internal Area
581 sq ft - 54 sq m

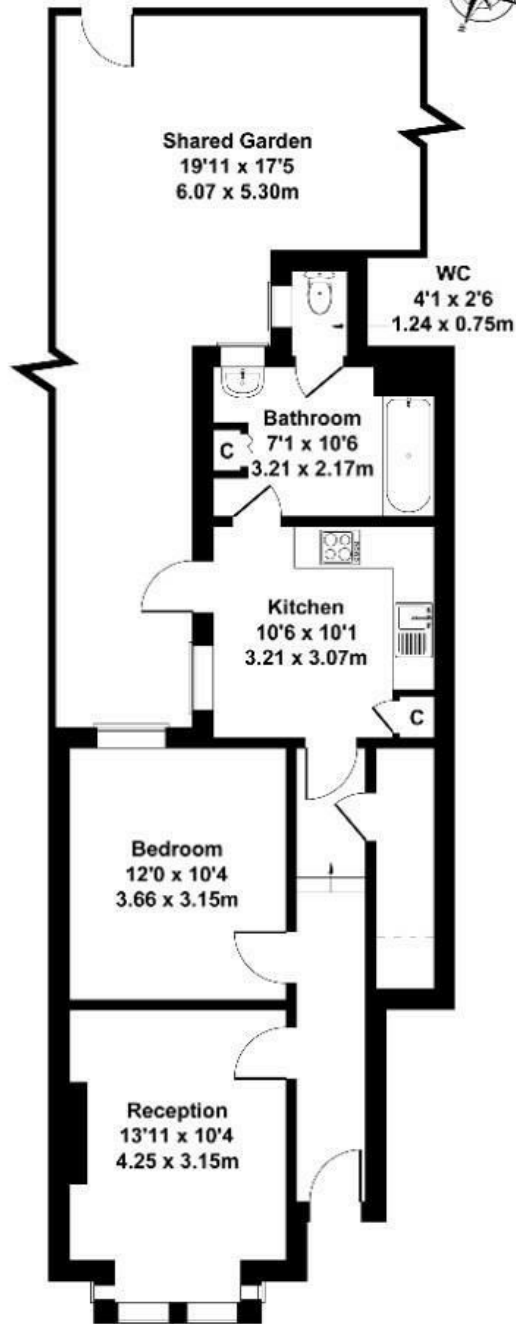

GROUND FLOOR

Not to Scale. Produced by The Plan Portal 2025
For Illustrative Purposes Only.

Energy Efficiency Rating		
	Current	Potential
Very energy efficient - lower running costs		
(92 plus) A		
(81-91) B		
(69-80) C		76
(55-68) D	61	
(39-54) E		
(21-38) F		
(1-20) G		
Not energy efficient - higher running costs		
England & Wales		EU Directive 2002/91/EC