

The Grove, W5

LONG LET: A stunningly large, raised ground floor, one-bedroom, period conversion apartment that is located on the doorstep of Ealing Broadway.

- ONE BEDROOM FLAT
- MODERN INTERIOR
- HIGH CEILINGS
- DIRECT ACCESS TO PRIVATE SOUTH FACING GARDEN
- CLOSE PROXIMITY TO EALING BROADWAY
- PERMIT PARKING

£2,000

The Grove

Approximate Gross Internal Area
515 sq ft - 48 sq m

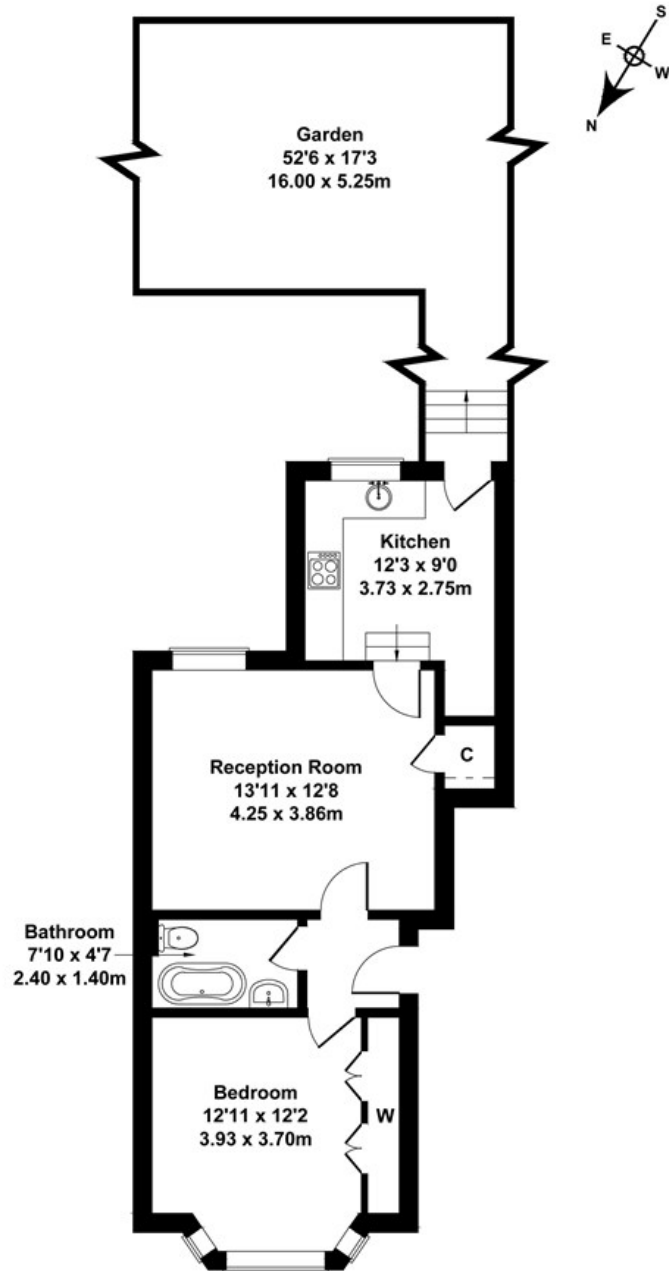

GROUND FLOOR

Not to Scale. Produced by The Plan Portal 2022
For Illustrative Purposes Only.

Energy Efficiency Rating		
	Current	Potential
Very energy efficient - lower running costs		
(92 plus) A		
(81-91) B		
(69-80) C		
(55-68) D		
(39-54) E		
(21-38) F		
(1-20) G		
Not energy efficient - higher running costs		
England & Wales	EU Directive 2002/91/EC	