



Allison Road, W3

LONG LET. Situated in a quiet residential street, this two-bedroom flat is beautifully presented and benefits from a great location.

- COMMUNAL GARDEN
- GREAT TRANSPORT LINKS
- OPEN PLAN KITCHEN
- TWO BEDROOMS
- AVAILABLE NOW
- CLOSE TO LOCAL AMENITIES

£1,900 PCM

F4 - Allison Road

Approximate Gross Internal Area
506 sq ft - 47 sq m

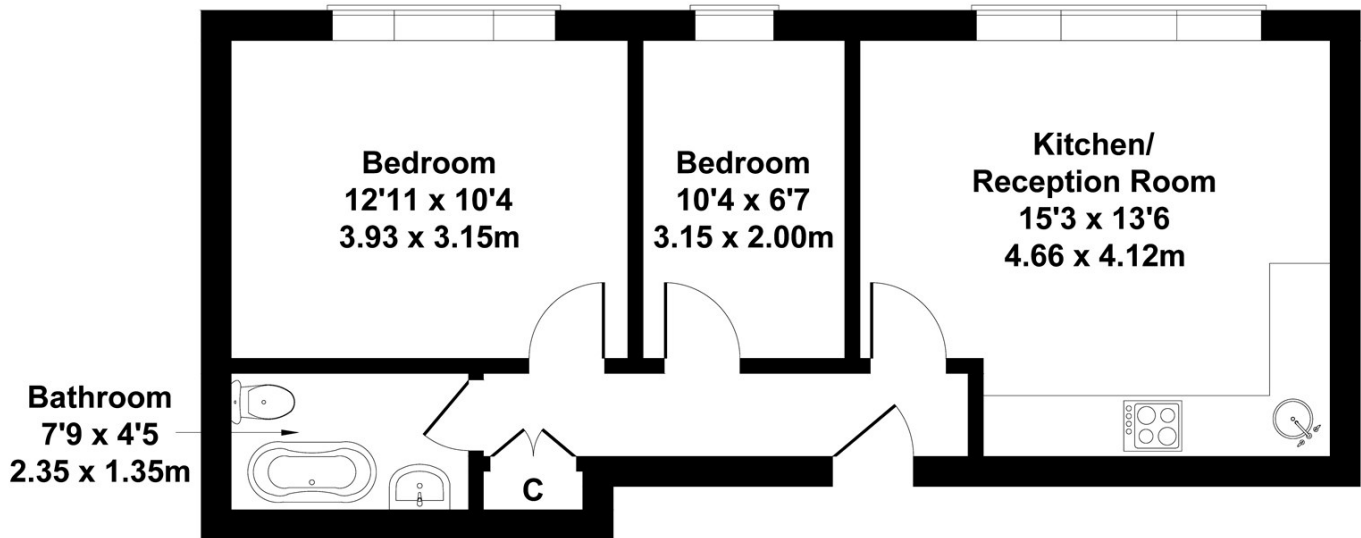
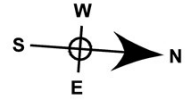

FIRST FLOOR

Not to Scale. Produced by The Plan Portal 2021
For Illustrative Purposes Only.

Energy Efficiency Rating		
	Current	Potential
Very energy efficient - lower running costs		
(92 plus) A		
(81-91) B		
(69-80) C		
(55-68) D		
(39-54) E		
(21-38) F		
(1-20) G		
Not energy efficient - higher running costs		
England & Wales	EU Directive 2002/91/EC	