



The Grove, W5

A stunning large one-bedroom period conversion garden flat located moments from Ealing Broadway centre.

The property is situated on the raised ground floor and comprises of a large reception, separate kitchen, large double bedroom and stylish family bathroom. The property has high ceiling, abundance of light and direct access to a large private south facing garden.

The property comes with a long lease of 123 years and no onward chain.

£495,000

- Garden flat
- Large one bedroom
- Huge south facing garden
- High Ceilings
- Sought after location
- Close to transport links
- Short walk to centre of Ealing Broadway
- Separate kitchen
- Refurbished recently
- Good storage

The Grove

Approximate Gross Internal Area
515 sq ft - 48 sq m

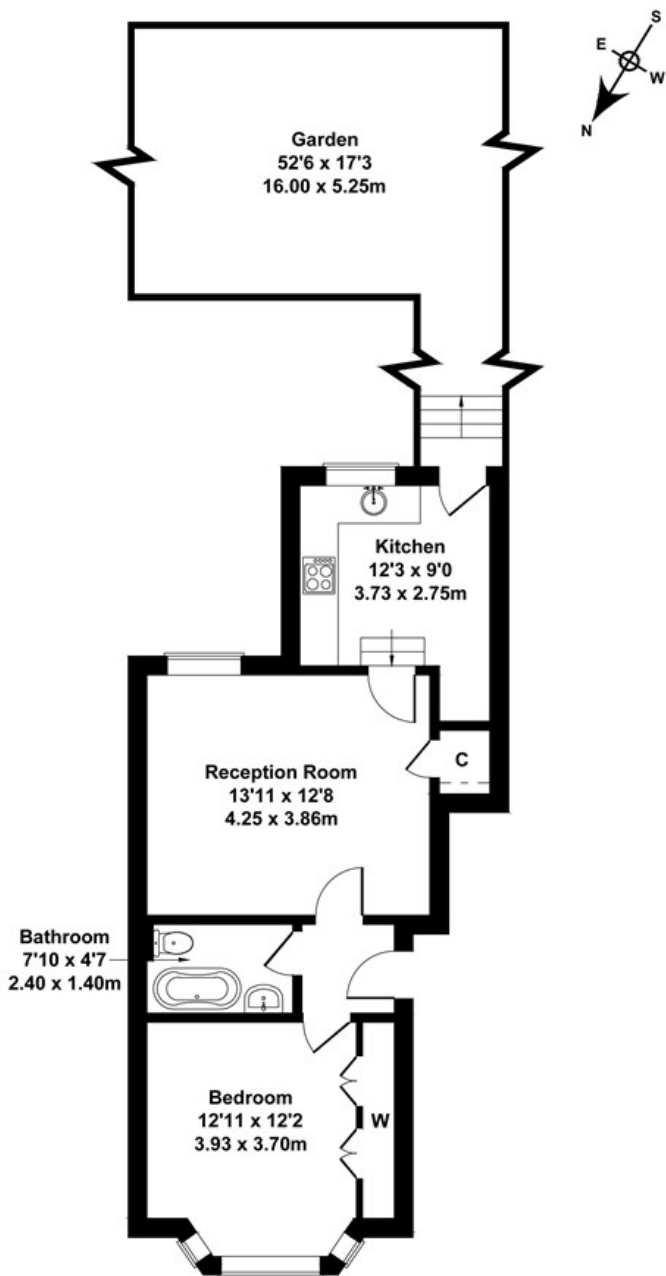

GROUND FLOOR

Not to Scale. Produced by The Plan Portal 2022
For Illustrative Purposes Only.

Energy Efficiency Rating		
	Current	Potential
<i>Very energy efficient - lower running costs</i>		
(92 plus) A		
(81-91) B		
(69-80) C		
(55-68) D		
(39-54) E		
(21-38) F		
(1-20) G		
<i>Not energy efficient - higher running costs</i>		
England & Wales	EU Directive 2002/91/EC	