



Selby Road, W5

Long Let. Nestled on the ever-popular Selby Road, this beautifully presented three-bedroom semi-detached home blends period charm with modern convenience, offering generous living space and a private garden, ideal for family life and entertaining.

- THREE BEDROOM HOUSE
- SEPERATE KITCHEN
- GARAGE INCLUDED
- OFF STREET PARKING
- PRIVATE GARDEN
- AVAILABLE NOW

£3,500

Selby Road

Approximate Gross Internal Area
1076 sq ft - 100 sq m
(Excluding Garage)

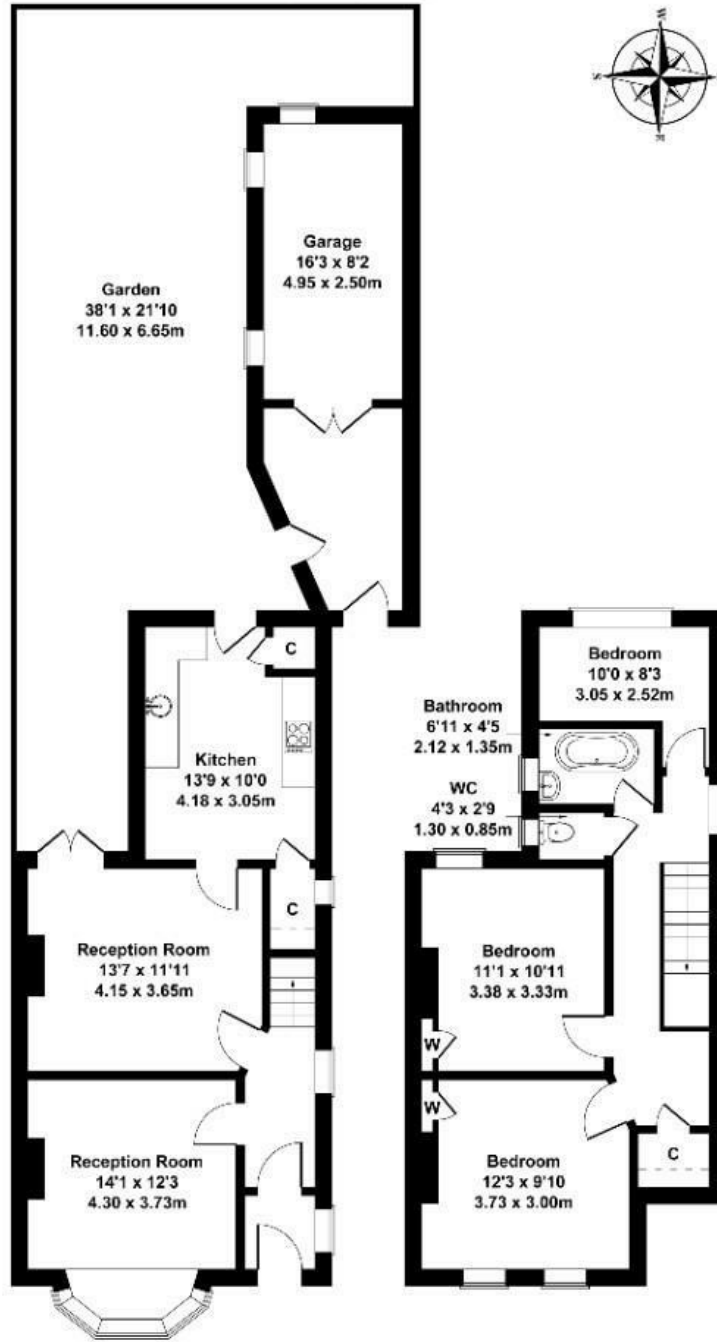

GROUND FLOOR

FIRST FLOOR

Not to Scale. Produced by The Plan Portal 2025
For Illustrative Purposes Only.

Energy Efficiency Rating		
	Current	Potential
Very energy efficient - lower running costs		
(92 plus) A		
(81-91) B		
(69-80) C		
(55-68) D		
(39-54) E	51	
(21-38) F		
(1-20) G		
Not energy efficient - higher running costs		
England & Wales		EU Directive 2002/91/EC