



Gordon House, W5

LONG LET. This well presented two bedroom flat benefits from a great location close to transport links.

- TWO SPACIOUS BEDROOMS
- LARGE RECEPTION ROOM
- SMART KITCHEN
- STYLISH BATHROOM
- GREAT LOCATION
- PURPOSE BUILT APARTMENT

£1,700 PCM

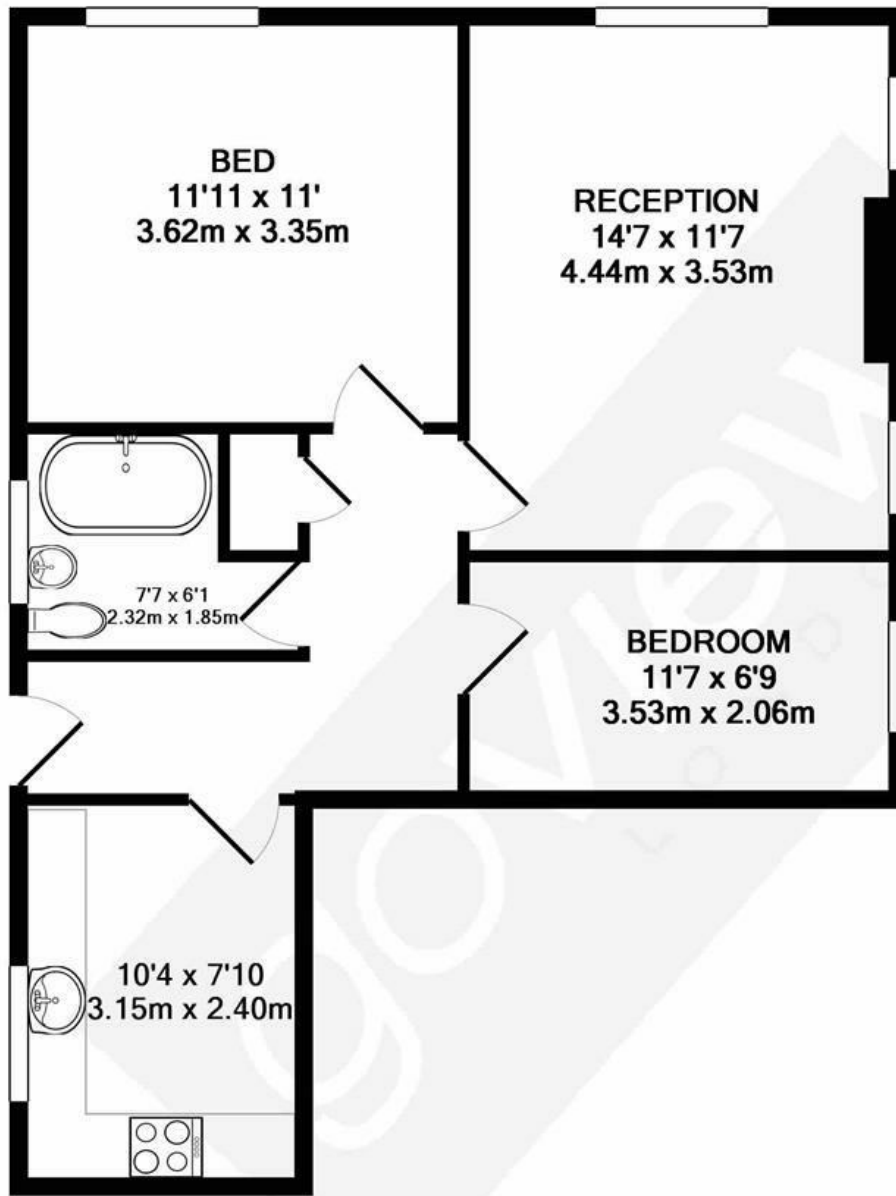

TOTAL APPROX. FLOOR AREA 565 SQ.FT. (52.5 SQ.M.)

Whilst every attempt has been made to ensure the accuracy of the floor plan contained here, measurements of doors, windows, rooms and any other items are approximate and no responsibility is taken for any error, omission, or mis-statement. This plan is for illustrative purposes only and should be used as such by any prospective purchaser. The services, systems and appliances shown have not been tested and no guarantee as to their operability or efficiency can be given
 Made with Metropix ©2018

Energy Efficiency Rating		Current	Potential
Very energy efficient - lower running costs			
(92 plus) A			
(81-91) B			
(69-80) C		72	83
(55-68) D			
(39-54) E			
(21-38) F			
(1-20) G			
Not energy efficient - higher running costs			
England & Wales	EU Directive 2002/91/EC		