



Waldegrave Road W5

Nestled in a peaceful cul-de-sac, this beautifully presented two-bedroom ground-floor flat is located within an elegant Edwardian period conversion. Retaining many of its original features, the property offers a perfect blend of period charm and modern potential.

Price Guide £475,000

Waldegrave Road

Approximate Gross Internal Area
624 sq ft - 58 sq m
(Excluding Outbuilding)

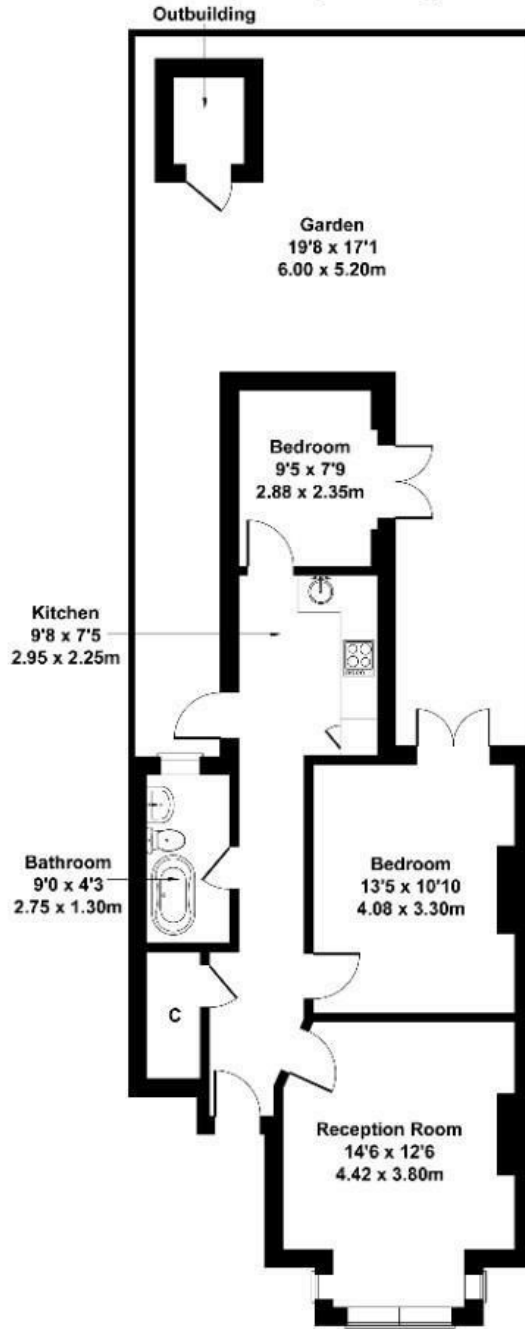

GROUND FLOOR

Not to Scale. Produced by The Plan Portal 2025
For Illustrative Purposes Only.

Energy Efficiency Rating		Current	Potential
Very energy efficient - lower running costs			
(92 plus) A			
(81-91) B			
(69-80) C			
(55-68) D			
(39-54) E			
(21-38) F			
(1-20) G			
Not energy efficient - higher running costs			
England & Wales		EU Directive 2002/91/EC	

63 → 74