

## Haymills Court, W5

LONG LET. Presented to a high standard this stunning two bedroom flat boasts modern interiors and is well located close to transport links and local amenities.

- TWO DOUBLE BEDROOMS
- CLOSE TO STATION
- OPEN PLAN RECEPTION
- MODERN KITCHEN
- FAMILY BATHROOM
- GREAT LOCATION

£1,850 PCM

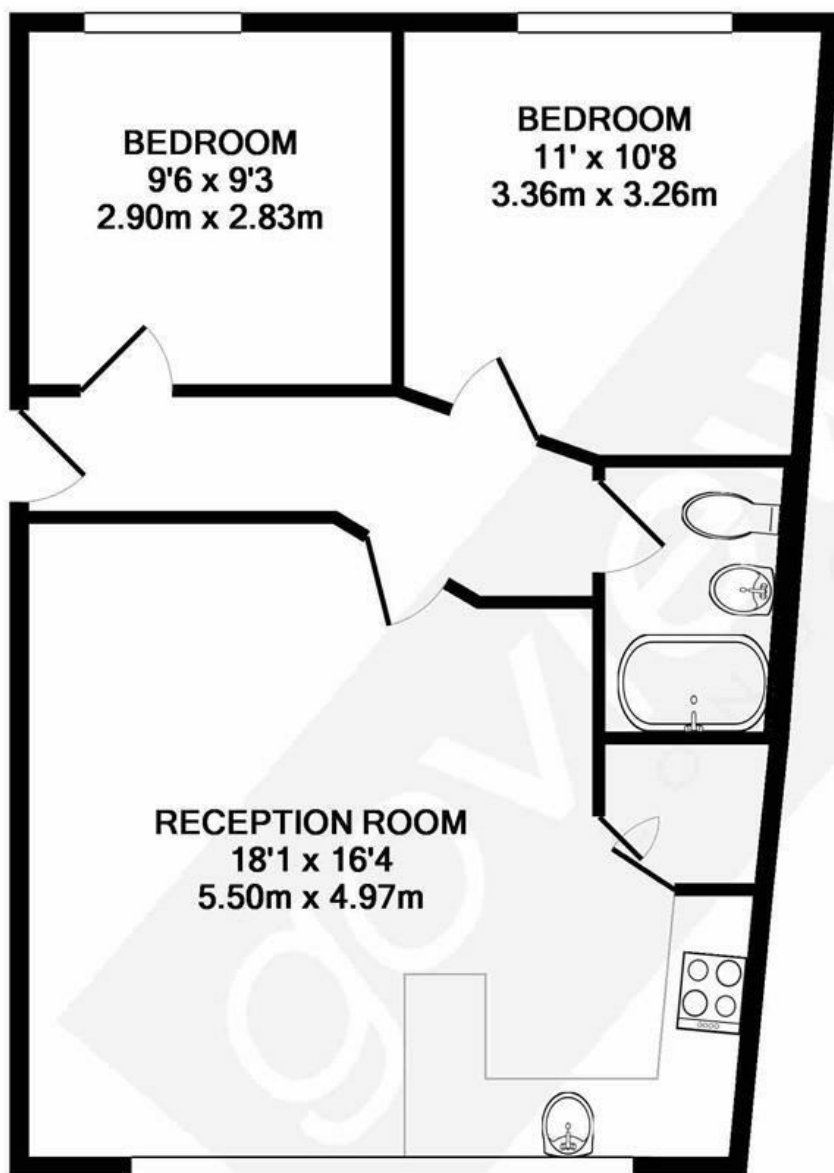

TOTAL APPROX. FLOOR AREA 578 SQ.FT. (53.7 SQ.M.)

Whilst every attempt has been made to ensure the accuracy of the floor plan contained here, measurements of doors, windows, rooms and any other items are approximate and no responsibility is taken for any error, omission, or mis-statement. This plan is for illustrative purposes only and should be used as such by any prospective purchaser. The services, systems and appliances shown have not been tested and no guarantee as to their operability or efficiency can be given

Made with Metropix ©2019

Energy Efficiency Rating		Current	Potential
Very energy efficient - lower running costs			
(92 plus) <b>A</b>			
(81-91) <b>B</b>			
(69-80) <b>C</b>			
(55-68) <b>D</b>			65
(39-54) <b>E</b>	44		
(21-38) <b>F</b>			
(1-20) <b>G</b>			
Not energy efficient - higher running costs			
<b>England &amp; Wales</b>	EU Directive 2002/91/EC		