



## Twyford Avenue, Acton

A very large three-bedroom apartment (926 sq ft), one main bathroom & WC with separate kitchen, set on the first floor of this period conversion in a popular residential road just a short walk from Ealing common and West Acton stations. The property comes with a share of the freehold, off-street parking and a communal garden.

- Three bedrooms
- Share of freehold
- Close to transport links
- Communal garden
- Off street parking
- 926 Sq ft

£525,000

# Twyford Avenue

Approximate Gross Internal Area  
926 sq ft - 86 sq m

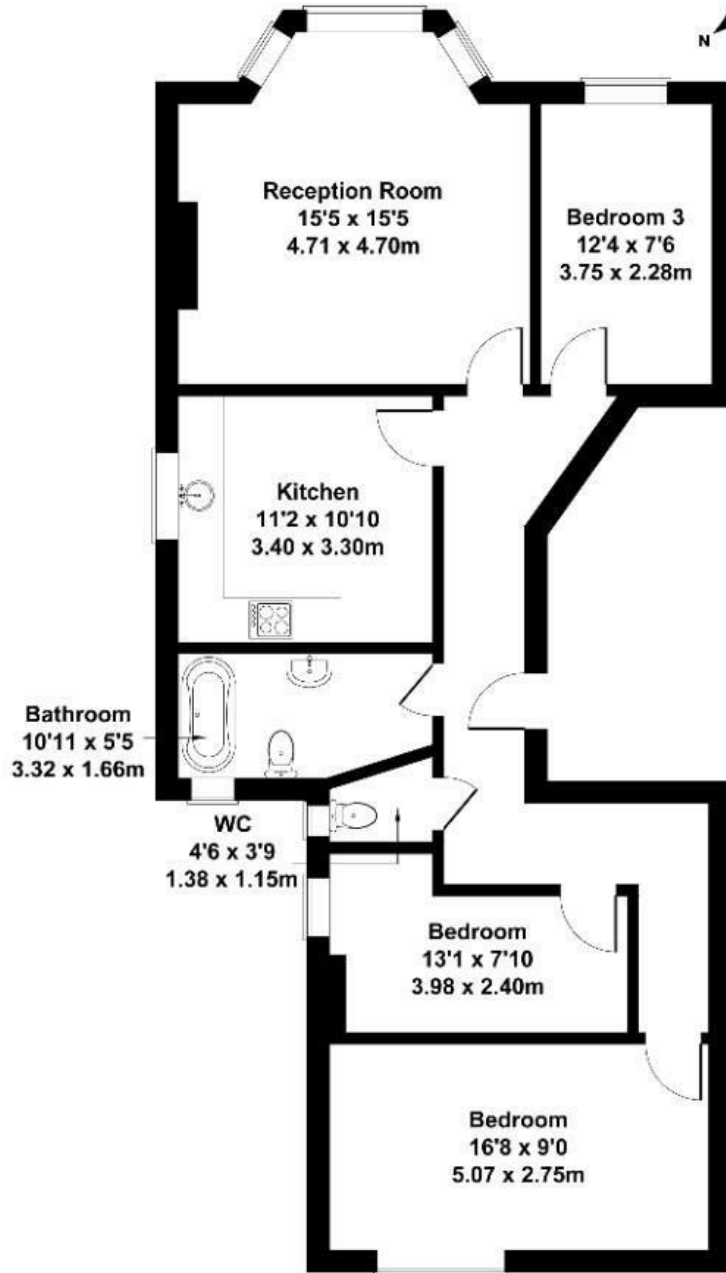
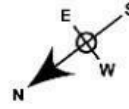

## FIRST FLOOR

Not to Scale. Produced by The Plan Portal 2024  
For Illustrative Purposes Only.

Energy Efficiency Rating		
	Current	Potential
Very energy efficient - lower running costs		
(92 plus) <b>A</b>		
(81-91) <b>B</b>		
(69-80) <b>C</b>		
(55-68) <b>D</b>		
(39-54) <b>E</b>		
(21-38) <b>F</b>		
(1-20) <b>G</b>		
Not energy efficient - higher running costs		
<b>England &amp; Wales</b>	EU Directive 2002/91/EC	

65 73