



## Woodville Gardens, W5

LONG LET. Well located close to transport links and amenities this well presented one bedroom flat boasts a great location in the heart of Ealing Broadway.

- ONE BEROOM FLAT
- GREAT LOCATION
- PRIVATE PARKING
- EALING BROADWAY
- COMMUNAL GARDEN
- CLOSE TO STATION

£1,600 PCM

# Flat 6 - Woodville Gardens

Approximate Gross Internal Area  
549 sq ft - 51 sq m

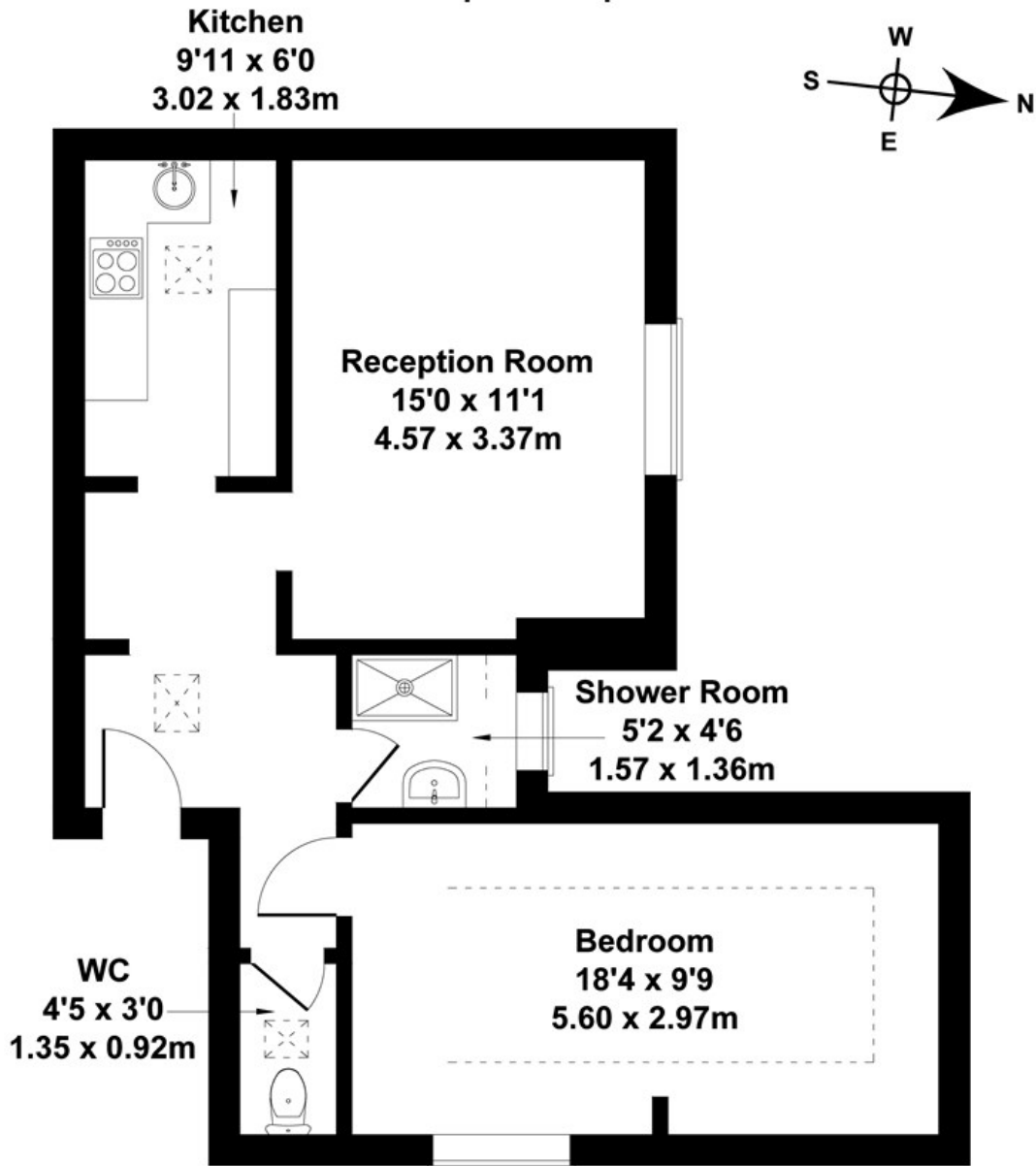

## SECOND FLOOR

Not to Scale. Produced by The Plan Portal 2021  
For Illustrative Purposes Only.

Energy Efficiency Rating		
	Current	Potential
<i>Very energy efficient - lower running costs</i>		
(92 plus) <b>A</b>		
(81-91) <b>B</b>		
(69-80) <b>C</b>		
(55-68) <b>D</b>		
(39-54) <b>E</b>		
(21-38) <b>F</b>		
(1-20) <b>G</b>		
<i>Not energy efficient - higher running costs</i>		
<b>England &amp; Wales</b>	EU Directive 2002/91/EC	