



## Gordon Road, W5

Long Let. A stunning Newly Refurbished 2-Bedroom Ground Floor Flat with Garage in Central Ealing Broadway – Available for Immediate Occupation.

- Ground floor flat
- Newly refurbished
- Private garage
- Close to amenities
- Close to Ealing Broadway
- Direct access to a communal garden

£2,399 Per Month

# Gordon Road

Approximate Gross Internal Area  
732 Sq Ft / 68 Sq M

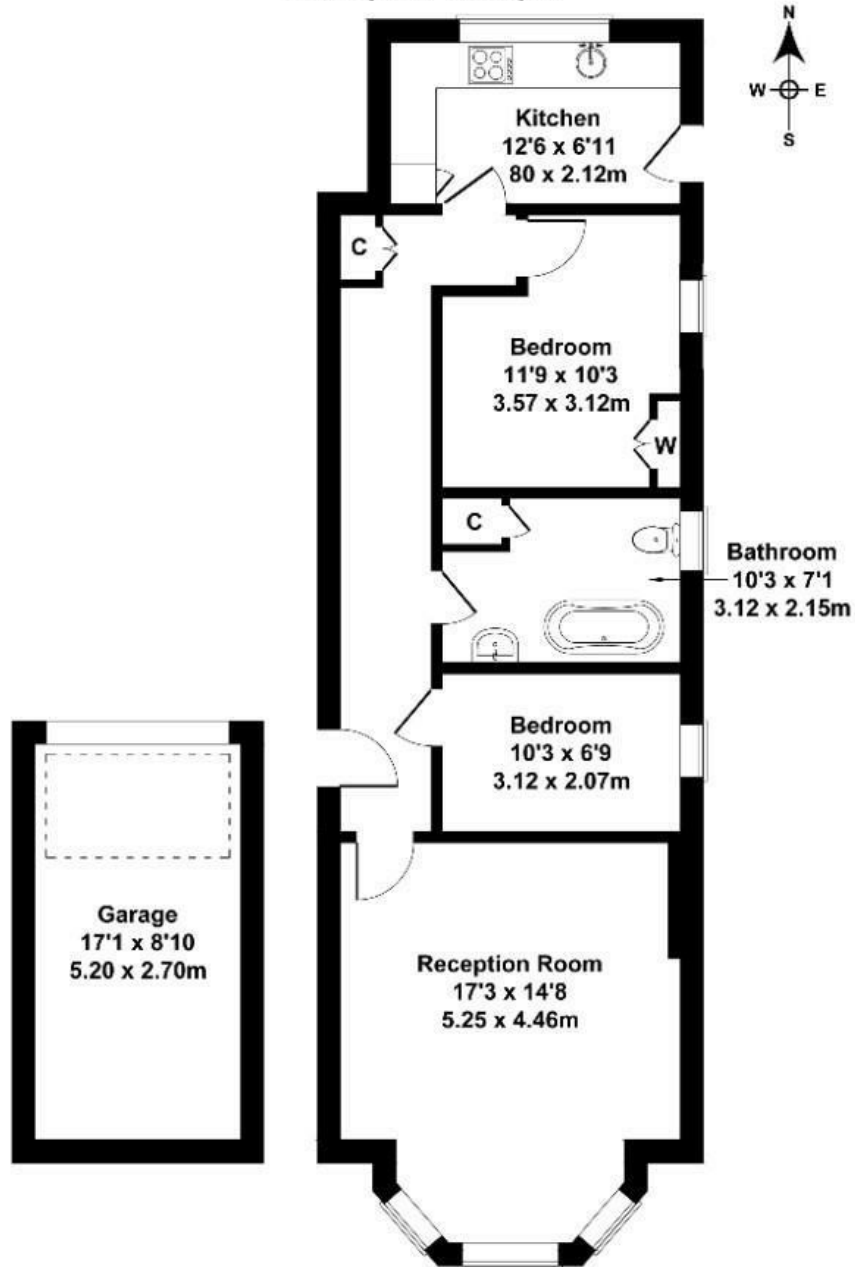

**GARAGE**

**GROUND FLOOR**

Not to Scale. Produced by The Plan Portal 2023  
For Illustrative Purposes Only.

Energy Efficiency Rating		Current	Potential
<i>Very energy efficient - lower running costs</i>			
(92 plus) <b>A</b>			
(81-91) <b>B</b>			
(69-80) <b>C</b>		69	77
(55-68) <b>D</b>			
(39-54) <b>E</b>			
(21-38) <b>F</b>			
(1-20) <b>G</b>			
<i>Not energy efficient - higher running costs</i>			
<b>England &amp; Wales</b>	EU Directive 2002/91/EC		