



Princes Road, London

LONG LET. This beautifully presented three bedroom town house boasts a modern interior and great location.

- THREE DOUBLE BEDROOMS
- TWO BATHROOMS
- GREAT LOCATION - CLOSE TO PARKS AND TRANSPORT
- LARGE RECEPTION ROOM
- PLENTY OF STORAGE
- FAMILY HOME

£2,900 Per Month

Princes Road

Approximate Gross Internal Area
1119 sq ft - 104 sq m

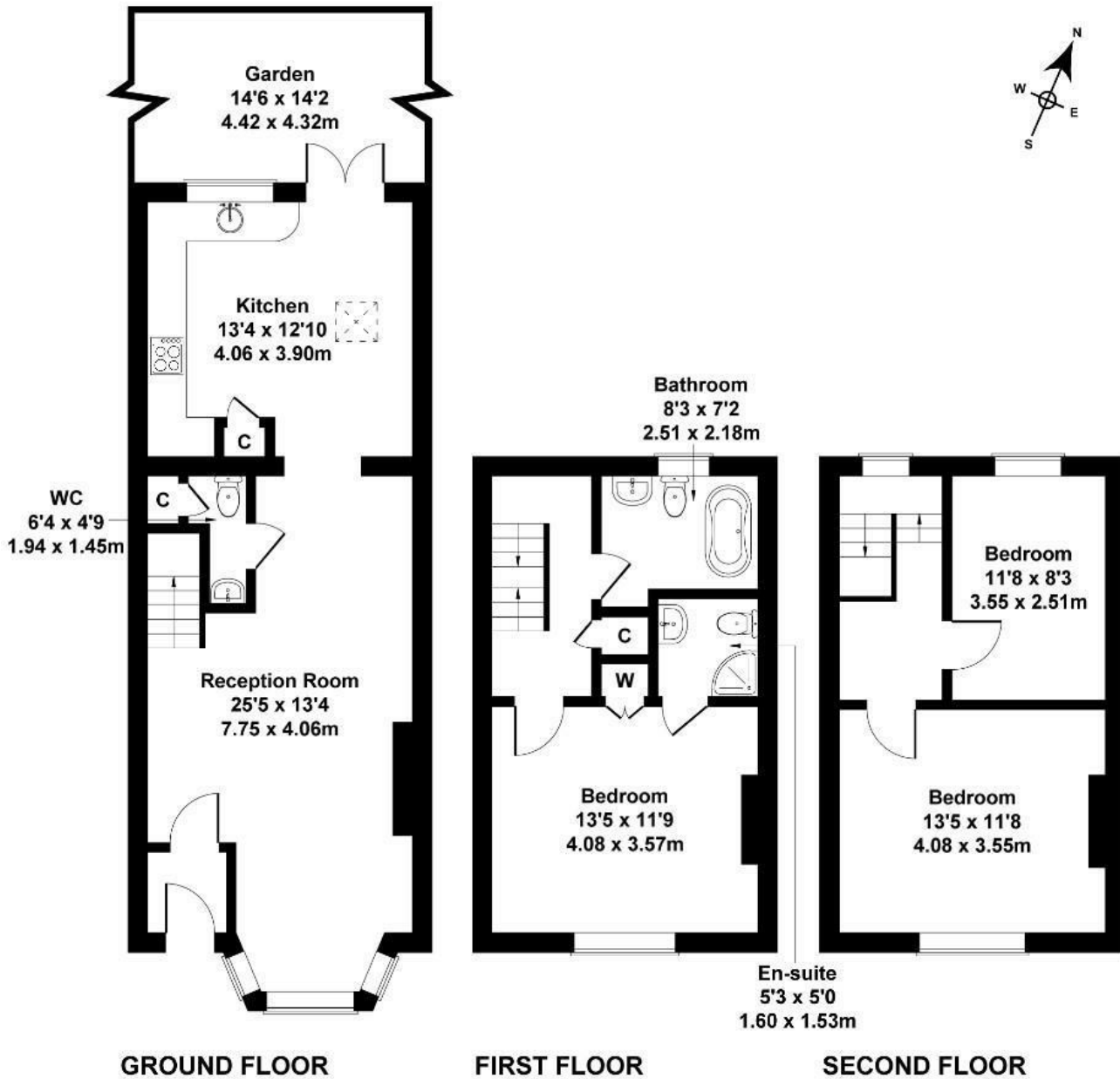

Not to Scale. Produced by The Plan Portal 2024
For Illustrative Purposes Only.

Energy Efficiency Rating		
	Current	Potential
<i>Very energy efficient - lower running costs</i>		
(92 plus) A		
(81-91) B		
(69-80) C		
(55-68) D		
(39-54) E		
(21-38) F		
(1-20) G		
<i>Not energy efficient - higher running costs</i>		
England & Wales	EU Directive 2002/91/EC	