



Denehurst Gardens, W3

Welcome to this charming apartment located in the desirable Denehurst Gardens, W3. This modern property boasts one reception room, one bedroom, and a well-appointed bathroom, making it an ideal space for a single professional or a couple looking for a cosy home.

- Open plan kitchen
- Available now
- Early viewing advised
- Separate storage unit
- Unfurnished
- Close to local transport

£1,700 PCM

Denehurst Gardens

Conversion
 1m = 3'3
 2m = 6'7
 3m = 9'11
 4m = 13'1
 5m = 16'5

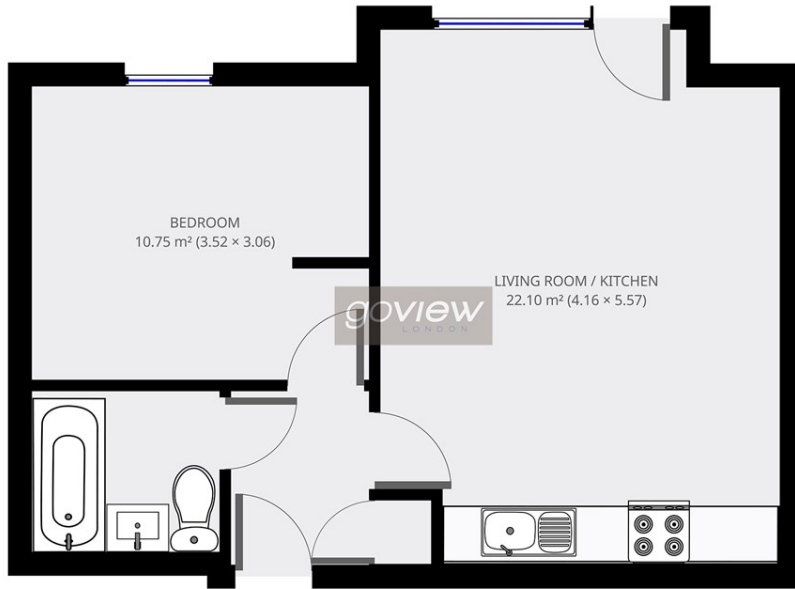

APPROX. GROSS INTERNAL FLOOR AREA: 40.5 sq. m / 435.9 sq.ft

WHILST EVERY ATTEMPT HAS BEEN MADE TO ENSURE THE ACCURACY OF THE FLOOR PLAN CONTAINED HERE, MEASUREMENTS OF DOORS, WINDOWS, ROOMS AND ANY OTHER ITEMS ARE APPROXIMATE AND NO RESPONSIBILITY IS TAKEN FOR ANY ERROR, OMISSION OR MIS-STATEMENT. THIS PLAN IS FOR ILLUSTRATIVE PURPOSES ONLY AND SHOULD BE USED AS SUCH, BY ANY PROSPECTIVE PURCHASER. THE SERVICES, SYSTEMS AND APPLIANCES SHOWN HAVE NOT BEEN TESTED AND NO GUARANTEE AS TO THEIR OPERABILITY OR EFFICIENCY CAN BE GIVEN.

© Avasmo Energy

Energy Efficiency Rating		
	Current	Potential
<i>Very energy efficient - lower running costs</i>		
(92 plus) A		
(81-91) B		
(69-80) C		
(55-68) D		
(39-54) E		
(21-38) F		
(1-20) G		
<i>Not energy efficient - higher running costs</i>		
England & Wales	EU Directive 2002/91/EC	