

## Castle Hill Parade, The Avenue, London

Centrally located in the heart of West Ealing is this stunning top floor two-bedroom conversion apartment that spans the entire width of a period residence and is presented in excellent decorative order having recently undergone a complete refurbishment.

Measuring approx. 517 sq ft, the property provides ample size for a buyer(s) looking for a good amount of space in a central West Ealing location where you can enjoy the range and depth of the town centre on your doorstep.

- Top floor flat
- Two bedrooms
- Completely refurbished
- Brand new lease
- No chain
- Short stroll to Elizabeth line station

£415,000

# Castle Hill Parade - The Avenue

Approximate Gross Internal Area  
517 sq ft - 48 sq m

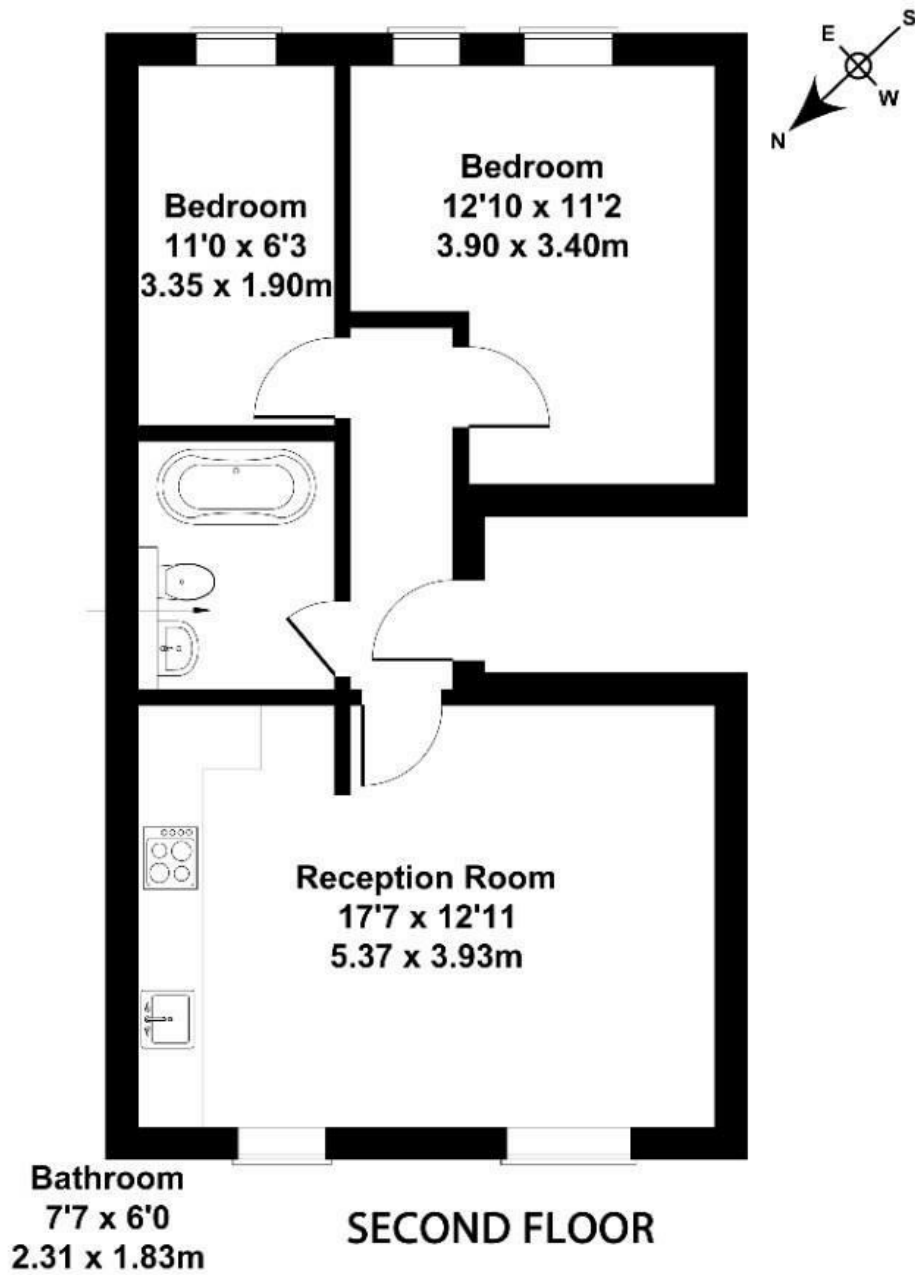

Not to Scale. Produced by The Plan Portal 2024  
For Illustrative Purposes Only.

| Energy Efficiency Rating                           |                            |           |
|--|----------------------------|-----------|
|  | Current                    | Potential |
| <i>Very energy efficient - lower running costs</i> |                            |           |
| (92 plus) <b>A</b>                                 |                            |           |
| (81-91) <b>B</b>                                   |                            |           |
| (69-80) <b>C</b>                                   |                            |           |
| (55-68) <b>D</b>                                   |                            |           |
| (39-54) <b>E</b>                                   |                            |           |
| (21-38) <b>F</b>                                   |                            |           |
| (1-20) <b>G</b>                                    |                            |           |
| <i>Not energy efficient - higher running costs</i> |                            |           |
| <b>England &amp; Wales</b>                         | EU Directive<br>2002/91/EC |           |