



## Castle Hill Parade, The Avenue, London

Centrally located on The Avenue, a prominent road in the heart of West Ealing is this stunning first floor two-bedroom conversion apartment that spans the entire width of a period residence and is presented in excellent decorative order having recently undergone a complete refurbishment.

Measuring approx. 527 sq ft, the property provides ample size for a buyer(s) looking for a good amount of space in a central West Ealing location where you can enjoy the range and depth of the town centre on your doorstep.

- Two bedrooms
- First floor
- Completely refurbished
- No chain
- Brand new lease
- 3 minute walk from West Ealing Station
- Elizabeth Line and over ground
- Period conversion

£414,995

# Castle Hill Parade - The Avenue

Approximate Gross Internal Area  
527 sq ft - 49 sq m

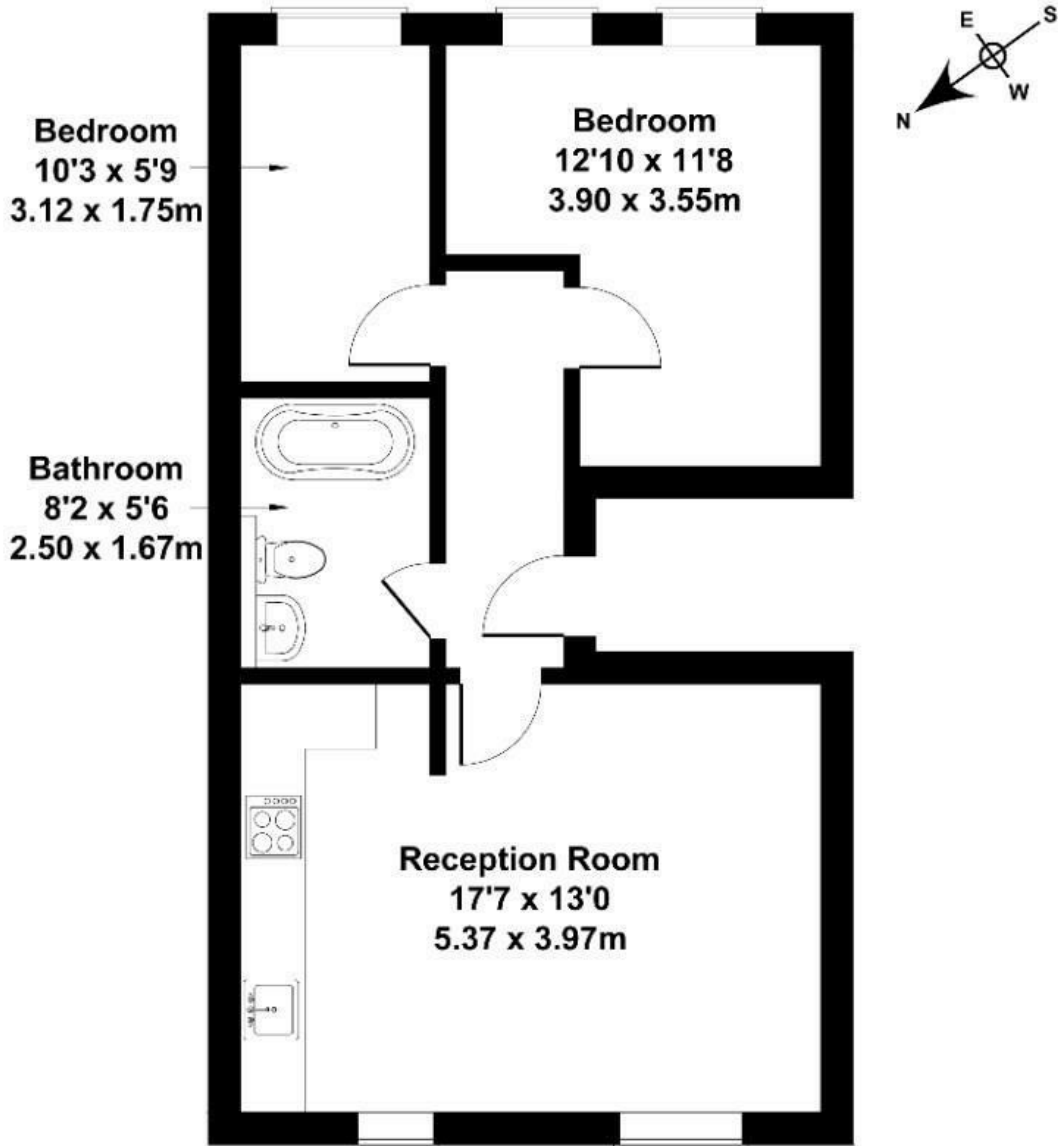

## FIRST FLOOR

Not to Scale. Produced by The Plan Portal 2024  
For Illustrative Purposes Only.

Energy Efficiency Rating		
	Current	Potential
<i>Very energy efficient - lower running costs</i>		
(92 plus) <b>A</b>		
(81-91) <b>B</b>		
(69-80) <b>C</b>		
(55-68) <b>D</b>		
(39-54) <b>E</b>		
(21-38) <b>F</b>		
(1-20) <b>G</b>		
<i>Not energy efficient - higher running costs</i>		
<b>England &amp; Wales</b>	EU Directive 2002/91/EC	