



Trentham Court, W3

LONG LET. Situated in a modern development this spacious one bedroom flat offers a modern interior, a great location and is available for immediate occupation.

- Available now
- Modern development
- North Acton underground station is minutes away
- Secure entry system
- Close to local amenities
- Part furnished

£1,650

Trentham Court

Approximate Gross Internal Area
463 sq ft - 43 sq m

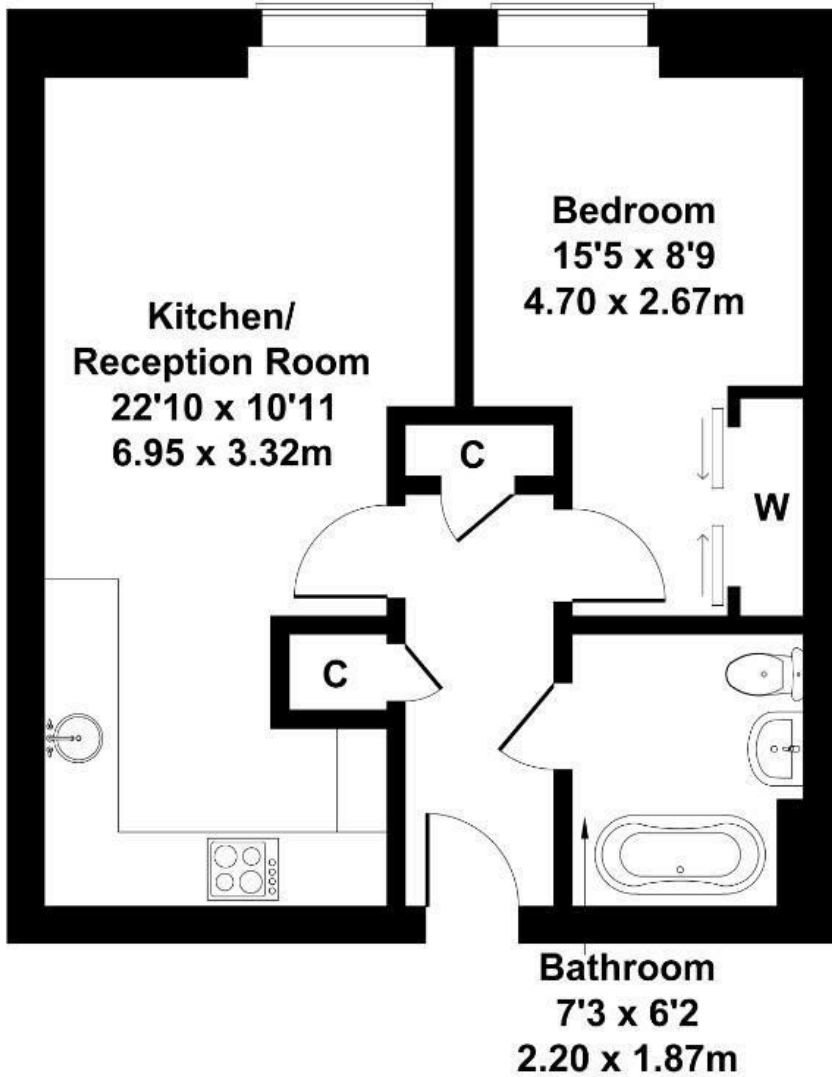
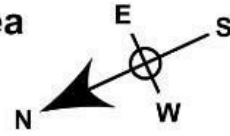

FIFTH FLOOR

Not to Scale. Produced by The Plan Portal 2024
For Illustrative Purposes Only.

Energy Efficiency Rating		
	Current	Potential
<i>Very energy efficient - lower running costs</i>		
(92 plus) A		
(81-91) B		
(69-80) C		
(55-68) D		
(39-54) E		
(21-38) F		
(1-20) G		
<i>Not energy efficient - higher running costs</i>		
England & Wales	EU Directive 2002/91/EC	