



Woodville Gardens, W5

A large top floor one bedroom period conversion set on one of Ealing's most sought after streets.

The property comes in good order throughout and set up as follows - large reception, double bedroom, separate kitchen and bathroom situated on the top floor of this imposing period building.

The property further benefits from its close proximity to Ealing Broadway, allocated parking, long lease 175 yrs, well groomed communal gardens and no onward chain.

- Large one bedroom period conversion
- 549 sq ft
- Allocated parking space
- Large communal gardens
- Short proximity to Ealing Broadway
- Long lease 175 yrs

£340,000

Flat 6 - Woodville Gardens

Approximate Gross Internal Area

549 sq ft - 51 sq m

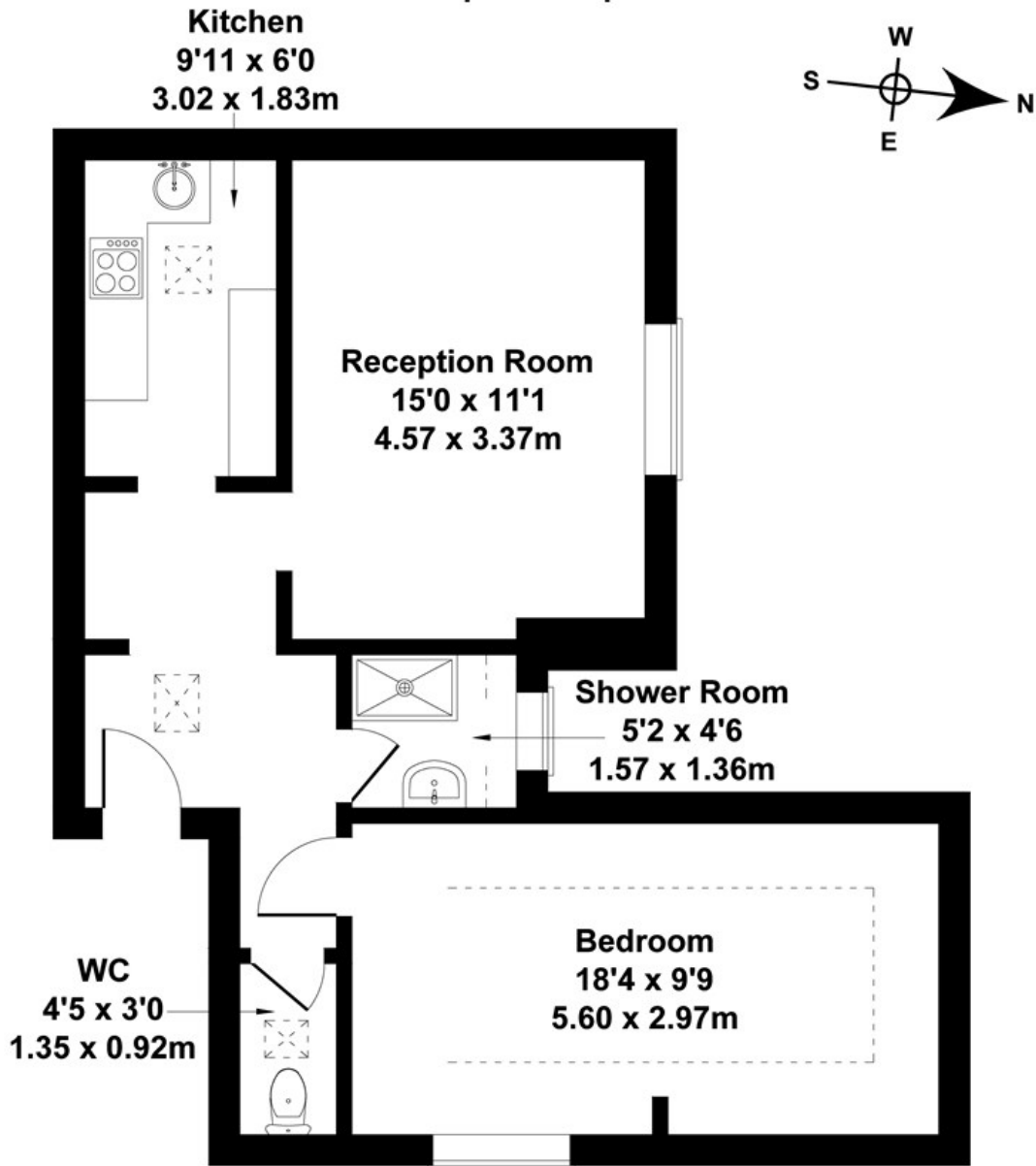

SECOND FLOOR

Not to Scale. Produced by The Plan Portal 2021
For Illustrative Purposes Only.

Energy Efficiency Rating		
	Current	Potential
<i>Very energy efficient - lower running costs</i>		
(92 plus) A		
(81-91) B		
(69-80) C		
(55-68) D	57	58
(39-54) E		
(21-38) F		
(1-20) G		
<i>Not energy efficient - higher running costs</i>		
England & Wales	EU Directive 2002/91/EC	