



Sandall Close, W5

Long let. This well presented two bedroom flat is located close to transport links and boasts spacious rooms throughout and access to outside space.

- Two double bedrooms
- Great location close to local transport
- Separate kitchen
- Garden
- Ideal for a couple or two sharers
- Walking distance from local amenities

£2,000 Per Month

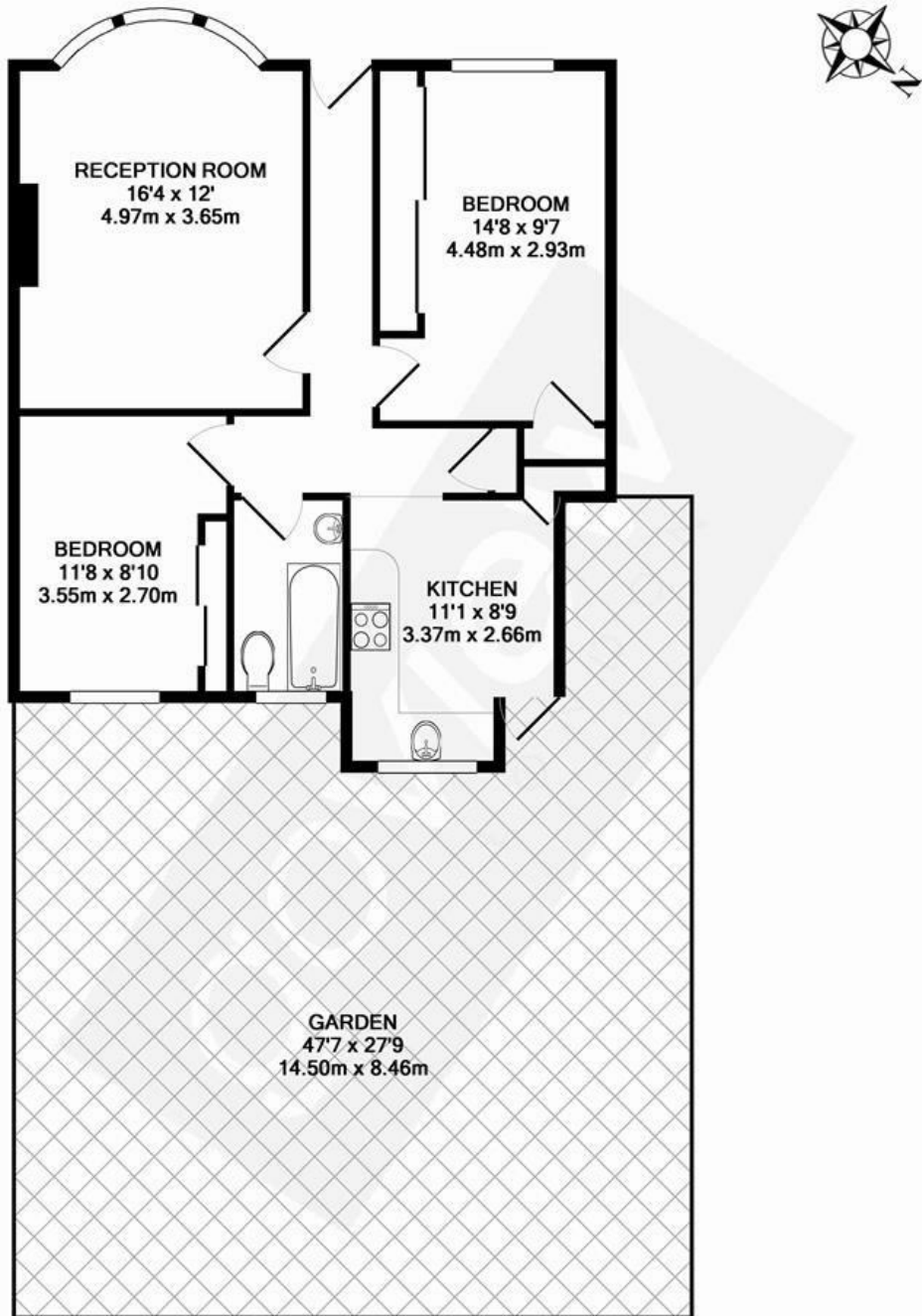

TOTAL APPROX. FLOOR AREA 641 SQ.FT. (59.5 SQ.M.)

Whilst every attempt has been made to ensure the accuracy of the floor plan contained here, measurements of doors, windows, rooms and any other items are approximate and no responsibility is taken for any error, omission, or mis-statement. This plan is for illustrative purposes only and should be used as such by any prospective purchaser. The services, systems and appliances shown have not been tested and no guarantee as to their operability or efficiency can be given
 Made with Metropix ©2016

Energy Efficiency Rating		
	Current	Potential
<i>Very energy efficient - lower running costs</i>		
(92 plus) A		
(81-91) B		
(69-80) C		
(55-68) D		
(39-54) E		
(21-38) F		
(1-20) G		
<i>Not energy efficient - higher running costs</i>		
England & Wales	EU Directive 2002/91/EC	