



## Sutherland Road, London

Apartment 1 is a three-bedroom, lower ground floor apartment spanning some 879 sq ft and benefits from its own private terrace. It provides a unique layout with central, open-plan reception with bay window centre piece, acting as the hub of the home with three good sized double bedroom and two bathrooms.

- Brand new development
- Three bedrooms
- Two bathrooms
- Private patio
- Communal gardens
- No chain
- Bespoke finish
- Close to Elizabeth Line

£760,000

# Sutherland Place

Approximate Gross Internal Area  
872 sq ft - 81 sq m

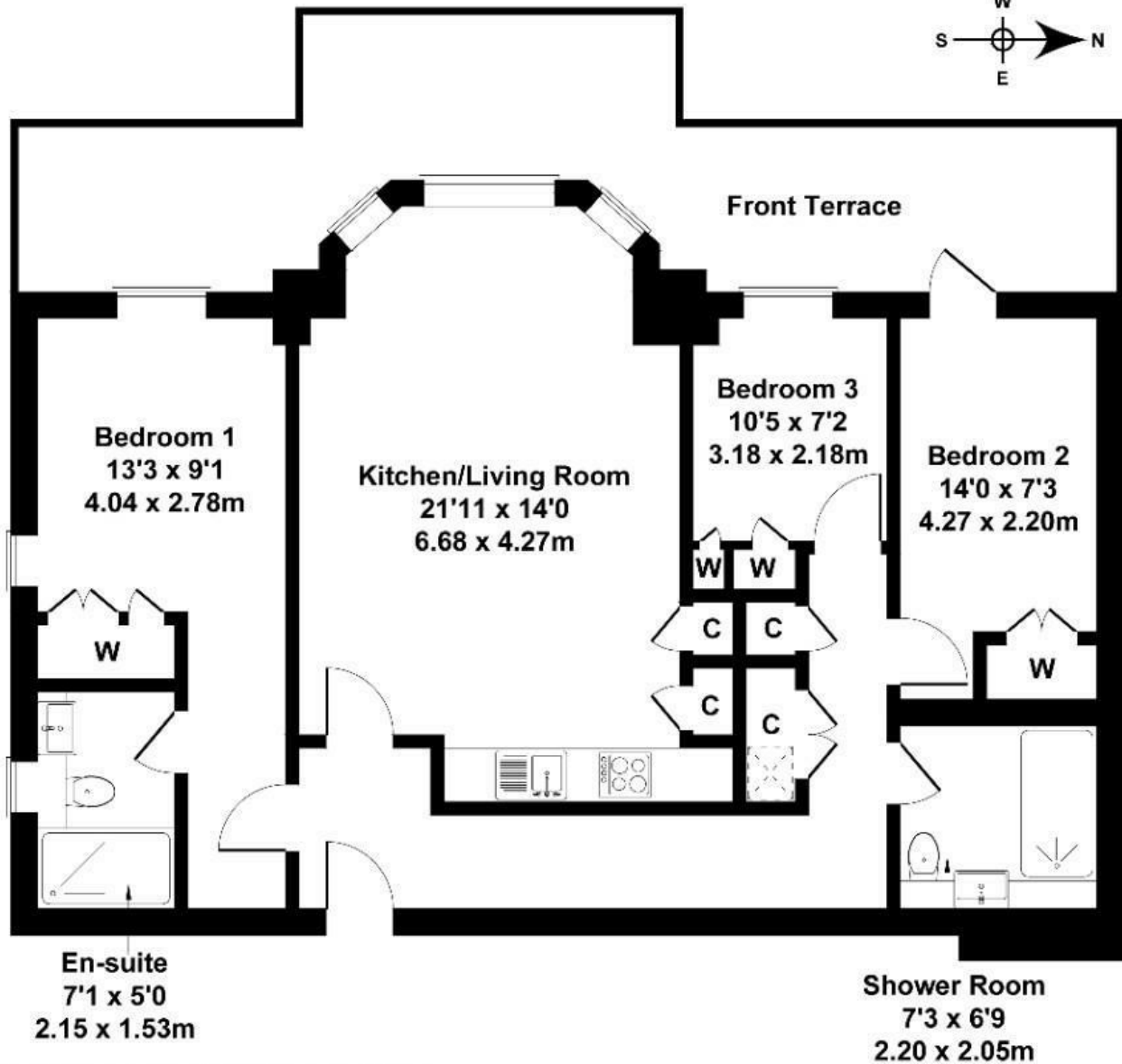
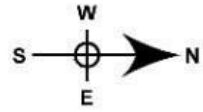

## LOWER GROUND FLOOR

Not to Scale. Produced by The Plan Portal 2024  
For Illustrative Purposes Only.

Energy Efficiency Rating		
	Current	Potential
Very energy efficient - lower running costs		
(92 plus) <b>A</b>		
(81-91) <b>B</b>		
(69-80) <b>C</b>		
(55-68) <b>D</b>		
(39-54) <b>E</b>		
(21-38) <b>F</b>		
(1-20) <b>G</b>		
Not energy efficient - higher running costs		
<b>England &amp; Wales</b>	EU Directive 2002/91/EC	