



## Lido House, Northfield Avenue, W13

LONG LET. This modern one bedroom flat is set within a superb development in the heart of West Ealing, moments from Ealing Broadway.

- COUNCIL TAX BAND-C
- MODERN DEVELOPMENT
- PRIVATE BALCONY
- CLOSE TO LOCAL TRANSPORT
- CLOSE TO STATION
- CLOSE TO AMENITIES

£1,675 PCM

# Lido House

Approximate Gross Internal Area  
538 sq ft - 50 sq m

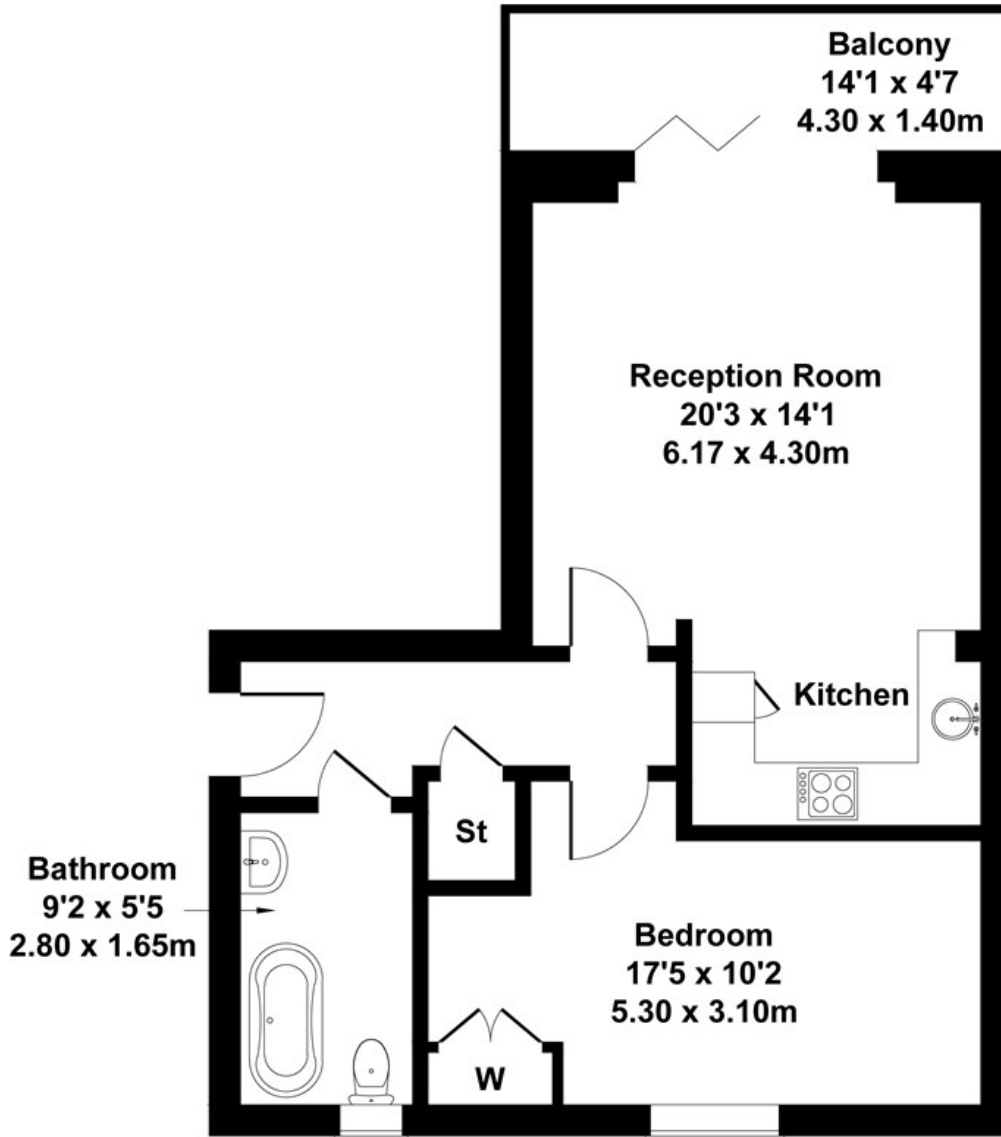
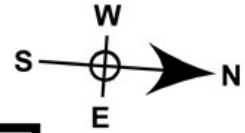

## FOURTH FLOOR

Not to Scale. Produced by The Plan Portal 2022  
For Illustrative Purposes Only.

Energy Efficiency Rating		Current	Potential
<i>Very energy efficient - lower running costs</i>			
(92 plus) <b>A</b>			
(81-91) <b>B</b>			
(69-80) <b>C</b>			
(55-68) <b>D</b>			
(39-54) <b>E</b>			
(21-38) <b>F</b>			
(1-20) <b>G</b>			
<i>Not energy efficient - higher running costs</i>			
<b>England &amp; Wales</b>	EU Directive 2002/91/EC		