



'Number One Ealing', Montpelier Rd, W5

An exceptionally large one bedroom apartment of some 581 sq ft with high ceilings located on the ground floor of the market-leading 'Number One Ealing' collection of new apartments. 999 year lease.

The property has a large second room that could be used as a bedroom, study or office.

- One bedroom plus study
- 581 sq ft
- Under floor heating
- Ground floor
- 993 years on lease
- Low service charges
- High ceilings
- No chain
- Close to Ealing Broadway
- Excellent condition throughout

£450,000

Montpelier Road

Approximate Gross Internal Area
581 sq ft - 54 sq m

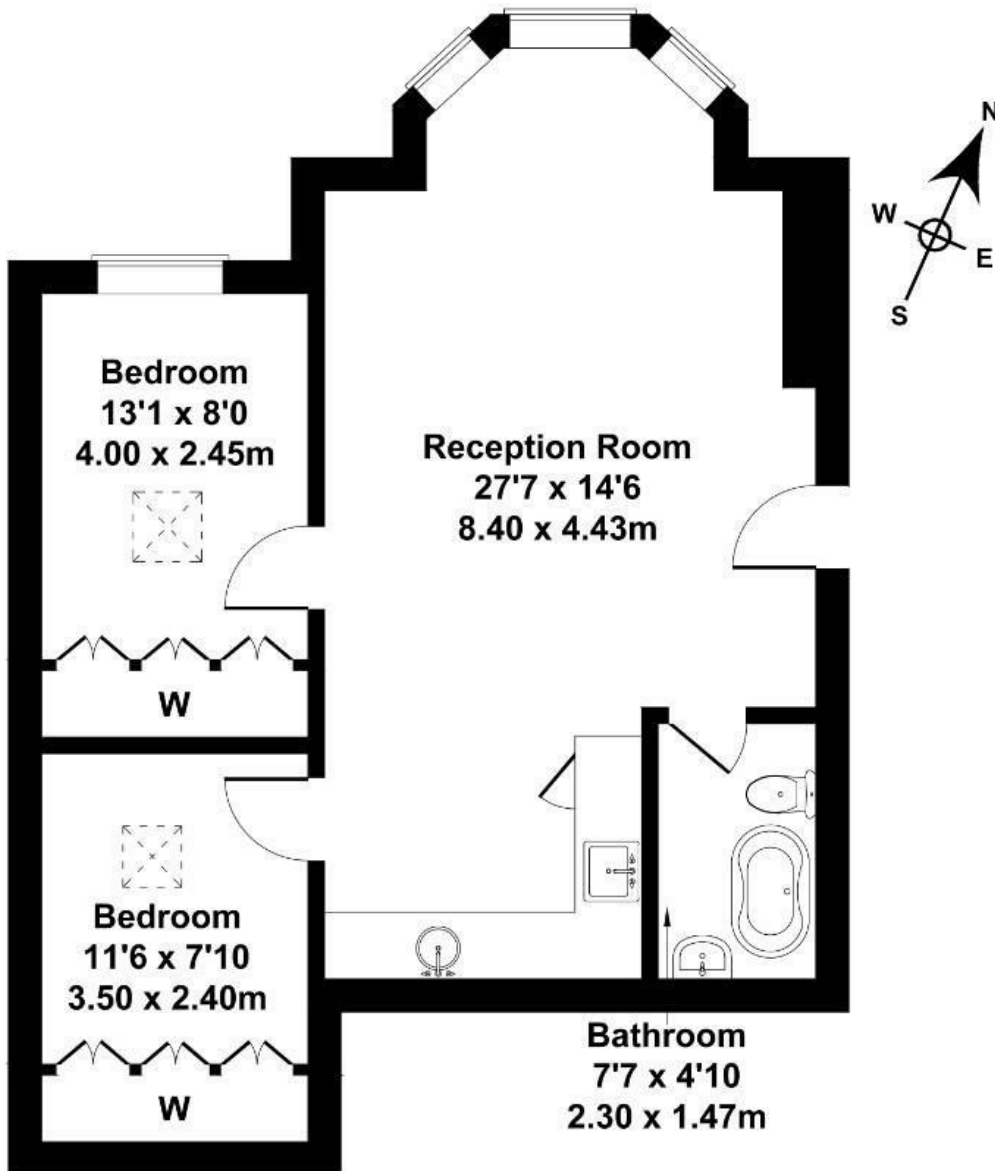

GROUND FLOOR

Not to Scale. Produced by The Plan Portal 2024
For Illustrative Purposes Only.

Energy Efficiency Rating		
	Current	Potential
<i>Very energy efficient - lower running costs</i>		
(92 plus) A		
(81-91) B		
(69-80) C	74	76
(55-68) D		
(39-54) E		
(21-38) F		
(1-20) G		
<i>Not energy efficient - higher running costs</i>		
England & Wales	EU Directive 2002/91/EC	