



## Glebe Court, Grange Road, London

Set on the ground floor of this popular three-storey development is this two double bedroom apartment in a prime residential spot just a short distance from the heart of Ealing Broadway.

The property is well-proportioned and set up as two double bedrooms that measures close to 800 sq ft with large eat in kitchen (10'2 x 9'8) and reception (15' x 14') and comes with a private garage, large well-groomed communal grounds, a share of the freehold and no onward chain

- Two double bedrooms
- Purpose built
- Ground floor flat
- Garage
- Share of Freehold
- Short walk to Ealing Broadway
- No chain
- Good condition throughout
- Utility room
- Close to multiple public transport links

£525,000

# Glebe Court

Approximate Gross Internal Area  
786 sq ft - 73 sq m  
(Excluding Garage)

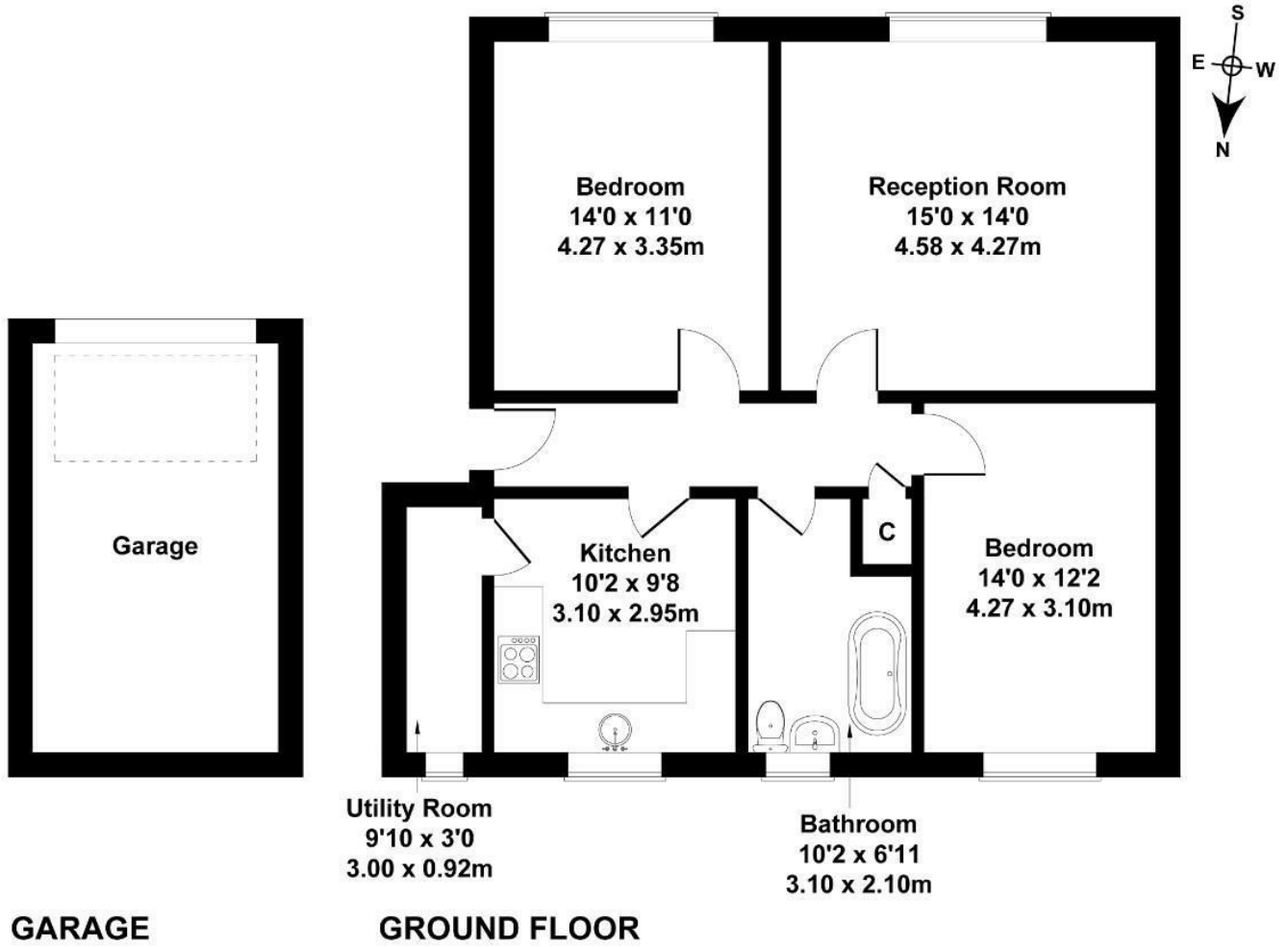

Not to Scale. Produced by The Plan Portal 2024  
For Illustrative Purposes Only.

Energy Efficiency Rating		
	Current	Potential
Very energy efficient - lower running costs		
(92 plus) <b>A</b>		
(81-91) <b>B</b>		
(69-80) <b>C</b>	69	75
(55-68) <b>D</b>		
(39-54) <b>E</b>		
(21-38) <b>F</b>		
(1-20) <b>G</b>		
Not energy efficient - higher running costs		
<b>England &amp; Wales</b>	EU Directive 2002/91/EC	