



## Holley Road W3

A ground floor purpose-built one bedroom flat, part of this popular development located near Southfield Recreation Ground Park and within walking distance of the very popular Chiswick High Road, Turnham Green Terrace and Churchfield Road, all offering an abundance of amenities.

The property is bright and provides good size accommodation as well as plenty of built-in storage.

- One bedroom apartment
- No onward chain
- Ground floor with access to the communal gardens
- Wood floors throughout
- Allocated off street parking
- Great transport links
- Ideal for investor
- CASH BUYERS ONLY ( 60 Year Lease remaining)

£215,000

# Holley Road

Approximate Gross Internal Area  
474 sq ft - 44 sq m

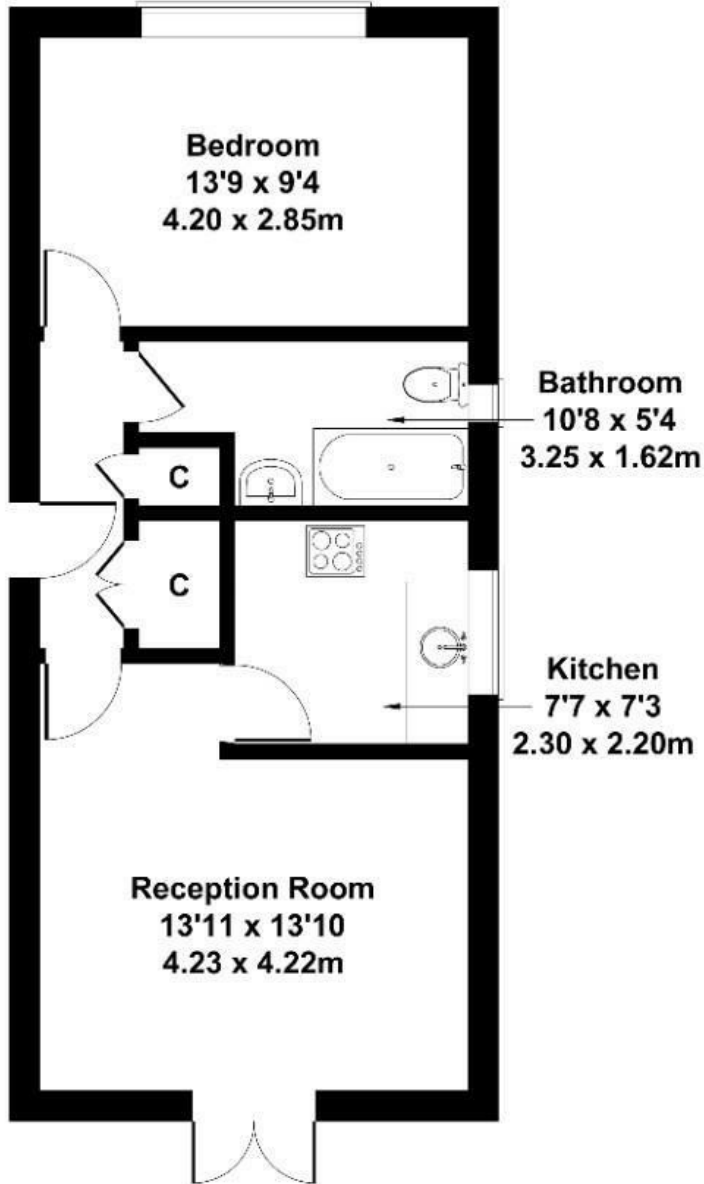

## GROUND FLOOR

Not to Scale. Produced by The Plan Portal 2024  
For Illustrative Purposes Only.

Energy Efficiency Rating		
	Current	Potential
<i>Very energy efficient - lower running costs</i>		
(92 plus) <b>A</b>		
(81-91) <b>B</b>		
(69-80) <b>C</b>		
(55-68) <b>D</b>		
(39-54) <b>E</b>		
(21-38) <b>F</b>		
(1-20) <b>G</b>		
<i>Not energy efficient - higher running costs</i>		
<b>England &amp; Wales</b>	EU Directive 2002/91/EC	