



95 Ealing Village, London, W5 2EA

A two bedroom apartment in the well renowned Ealing Village development. A development of note in particular to those who appreciate art-deco design and whose large, well appointed apartments with south-facing orientation from principal rooms and benefiting from extensive communal grounds and resident facilities always create excitement in the market.

- Secure private development
- Two bedrooms
- Private balcony
- Communal swimming pool
- No chain
- Off street parking
- Gated entrance
- Short walk to Ealing Broadway
- Separate kitchen
- Extensive communal gardens

£415,000

Ealing Village

Approximate Gross Internal Area
635 sq ft - 59 sq m

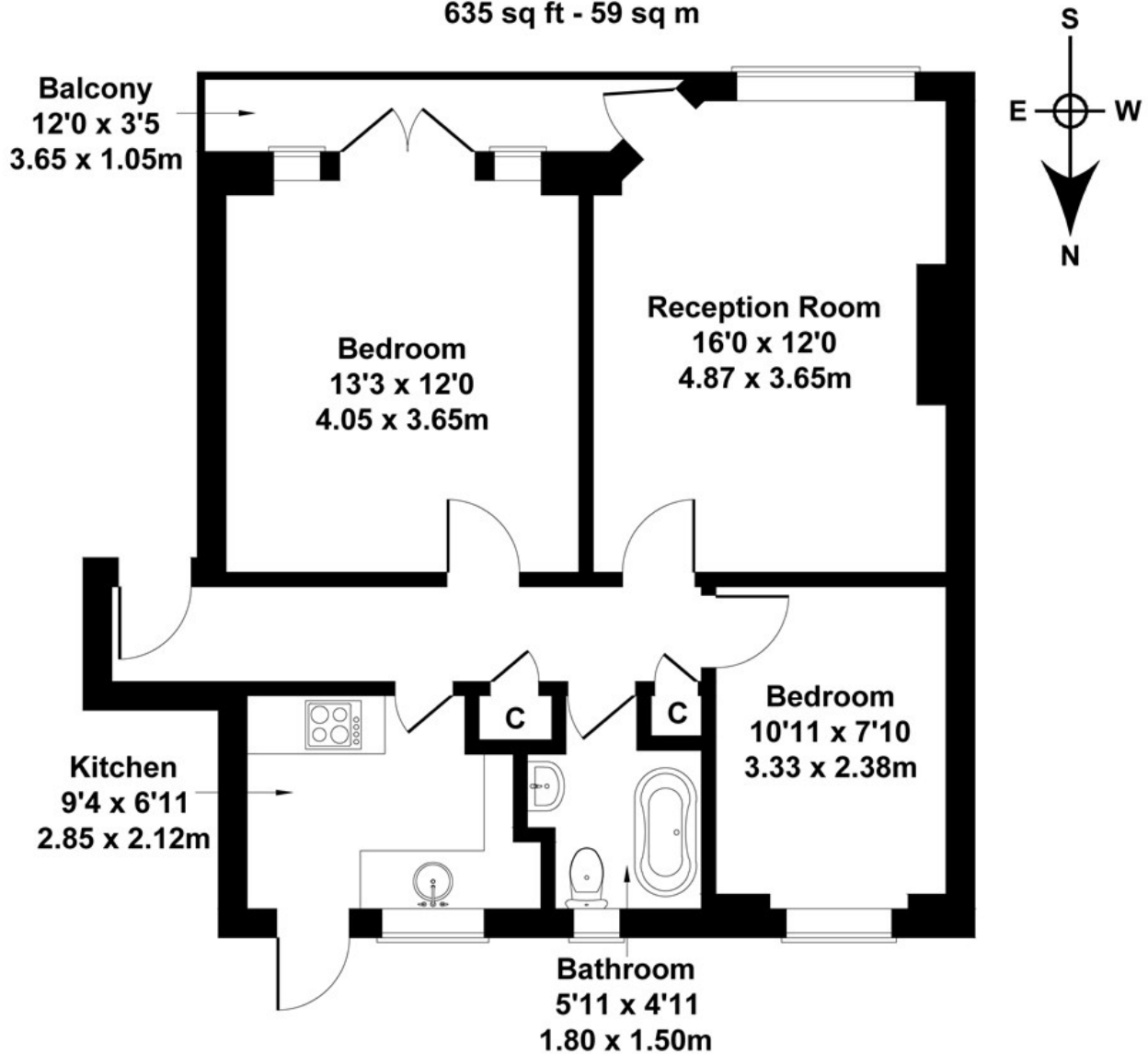

SECOND FLOOR

Not to Scale. Produced by The Plan Portal 2023
For Illustrative Purposes Only.

Energy Efficiency Rating		Current	Potential
Very energy efficient - lower running costs			
(92 plus) A			
(81-91) B			
(69-80) C			
(55-68) D			
(39-54) E		37	53
(21-38) F			
(1-20) G			
Not energy efficient - higher running costs			
England & Wales	EU Directive 2002/91/EC		