



Gunnersbury Avenue, London

A ground floor studio apartment located between Ealing Common and to Acton Town Tube. Ideal opportunity for someone to put their own stamp on the apartment, Ideal for a First time buyer or a investor or maybe even a pied-a-terre.

- Studio apartment
- Ground floor
- 999 Year lease
- Chain free
- Located between Ealing Common & Acton Town Underground Stations
- Ideal for FTB or Investment

£179,950

Gunnersbury Ave

Approximate Gross Internal Area
194 sq ft - 18 sq m

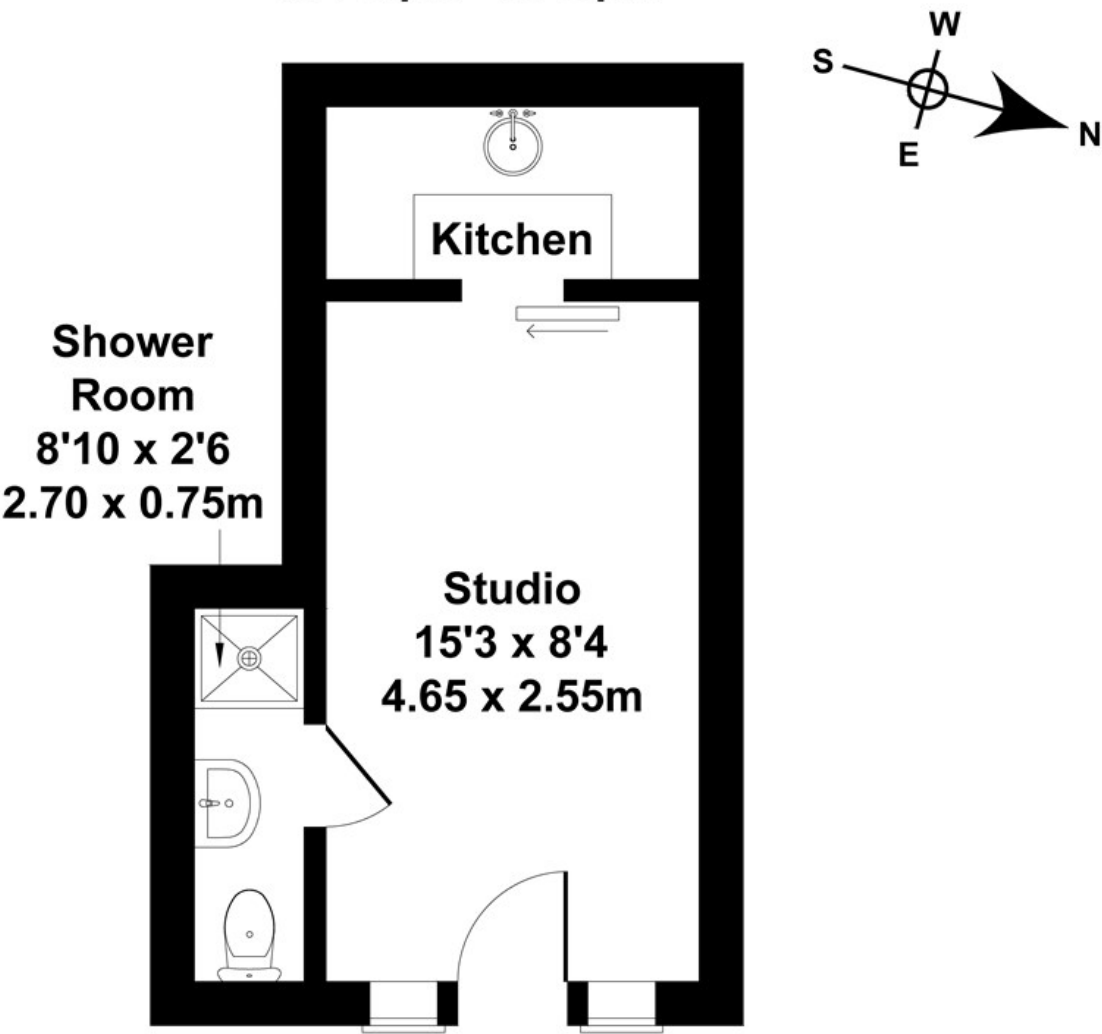

GROUND FLOOR

Not to Scale. Produced by The Plan Portal 2023
For Illustrative Purposes Only.

Energy Efficiency Rating		
	Current	Potential
Very energy efficient - lower running costs		
(92 plus) A		
(81-91) B		
(69-80) C		
(55-68) D		
(39-54) E		
(21-38) F		
(1-20) G		
Not energy efficient - higher running costs		
England & Wales	EU Directive 2002/91/EC	