



## Creswick Road, W3

A grand, triple-fronted, six bedroom, detached home built on West Acton's famed Creswick Rd, a wide tree-lined road containing bespoke housing designs and large plots.

The home provides an overall size of approx. 3596 sq ft spread over three sumptuous floors. The space can be adapted and extended to suit a family's living requirements.

- Detached house
- Triple-fronted
- Six bedrooms
- Four bathrooms
- No chain
- Popular residential street
- Close to transport links
- Local schools
- Potential to extend STPP
- touching 3,600 sq ft

£2,200,000

**Creswick Road**  
Approximate Gross Internal Area  
3595 sq ft - 334 sq m

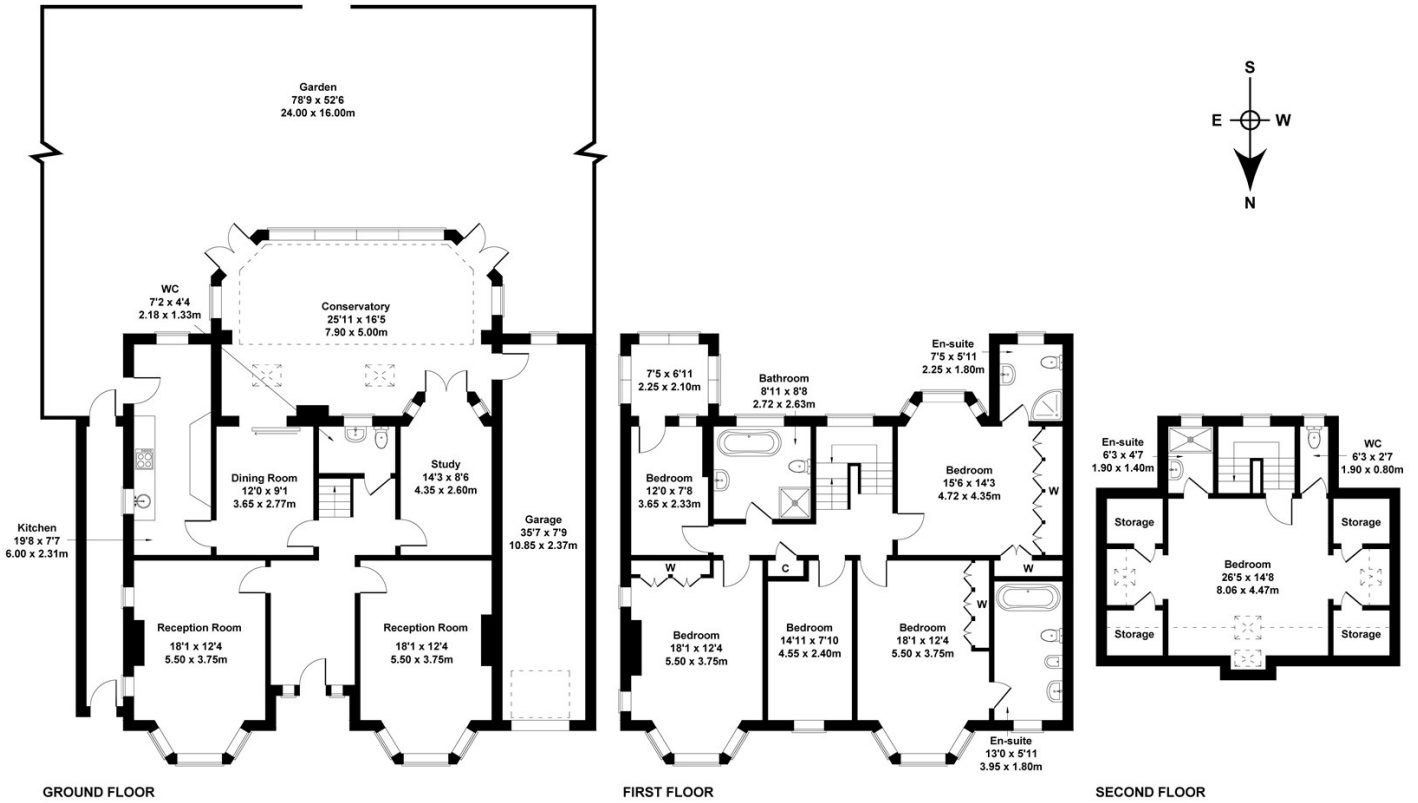

Not to Scale. Produced by The Plan Portal 2023  
For Illustrative Purposes Only.

Energy Efficiency Rating		Current	Potential
Very energy efficient - lower running costs			
(92 plus) <b>A</b>			
(81-91) <b>B</b>			
(69-80) <b>C</b>			
(55-68) <b>D</b>			
(39-54) <b>E</b>			
(21-38) <b>F</b>			
(1-20) <b>G</b>			
Not energy efficient - higher running costs			
<b>England &amp; Wales</b>		63	77
	EU Directive 2002/91/EC		